

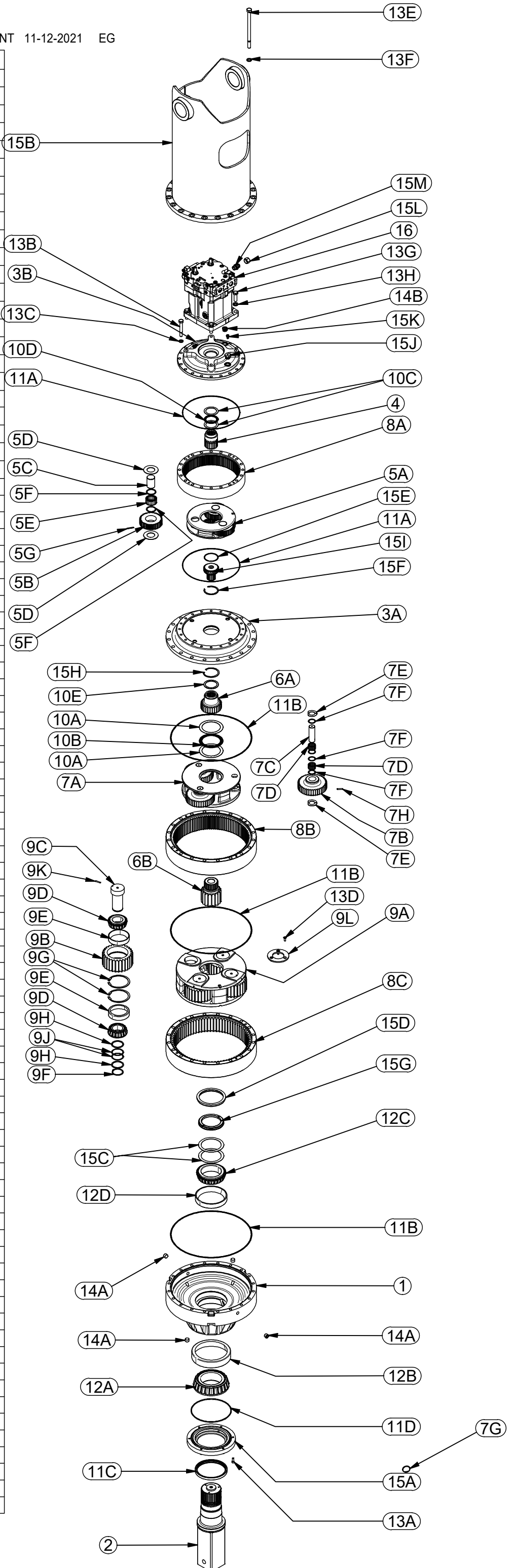

X1400155-54F189E5 EFFECTIVE FROM SN: 237505 FROM 1-1-2022 TO PRESENT 11-12-2021 EG

MODEL 1400155-54F189E5 DIGGER				
GROUP	ITEM	QTY	PART NUMBER	DESCRIPTION
	1	1	60-004-3014	BASE-FLANGELESS-F600/F1000
	2	1	60-004-4222L	SHAFT
	3A	1	60-004-1934	COVER
	3B	1	42-004-2032	COVER-SAE 'E' 440
	4	1	42-004-1532	INPUT GEAR - 5.87:1, 15T
5		(1)	42-005-0111	CARRIER ASSEMBLY - PRIMARY
	5A	1	42-004-1072	PRI CARRIER
	5B	3	42-004-1112	PLANET GEAR
	5C	3	42-004-1342	PLANET SHAFT
	5D	6	42-004-1362	THRUST WASHER
	5E	60	01-106-0040	PLANET ROLLER
	5F	6	42-004-1352	SPACER
	5G	3	01-153-0220	ROLL PIN
6	-	-	-	SUN GEARS
	6A	1	60-004-1402	INPUT GEAR
	6B	1	60-004-1792	SUN GEAR
7	-	(1)	60-005-2113	CARRIER ASSY - PRIMARY
	7A	1	60-004-6106	CARRIER-PRI(5:1) WHL DRIVE MOD
	7B	3	60-004-1862	PLANET GEAR-PRI
	7C	3	60-004-1272	PLANET SHAFT - PRI
	7D	168	01-106-0050	ROLLER BEARING
	7E	6	60-004-6110	WASHER - THRUST- PRI
	7F	12	60-004-1891	SPACER
	7G	3	01-160-0750	RETAINING RING; INTERNAL
	7H	3	01-153-0150	ROLL PIN
8	-	-	-	RING GEARS AND SPACERS
	8A	1	42-004-1042	RING GEAR - PRI
	8B	1	60-004-1193	RING GEAR - SEC- 600
	8C	1	60-004-1243	RING GEAR - SEC
9	-	(1)	60-005-2133	CARRIER ASSEMBLY, SEC
	9A	1	60-004-1774	CARRIER - SEC
	9B	4	60-004-1232	PLANET GEAR SEC
	9C	4	60-004-1262	PLANET SHAFT - SEC.
	9D	8	01-102-0210	TAPERED BEARING CONE
	9E	8	01-103-0210	TAPERED BEARING CUP
	9F	4	01-160-0490	RETAINING RING; EXTERNAL
	9G	8	01-160-0500	RETAINING RING
	9H	8	60-004-1291	WASHER - SEC. PLANET
	9J	8	60-004-1321	SHIM-SECONDARY PLANET
	9K	4	01-153-0150	ROLL PIN
	9L	1	60-004-1352	SECONDARY CARRIER RETAINER
10	-	-	-	THRUST WASHERS & BEARINGS
	10A	2	01-112-0350	THRUST RACE
	10B	1	01-112-0340	THRUST BRG
	10C	2	01-112-0400	THRUST WASHER
	10D	1	01-112-0410	BRG THRUST
	10E	1	01-112-0060	THRUST WASHER
11	-	-	-	SEALS & O-RINGS
	11A	2	01-402-0840	O-RING
	11B	3	01-402-0660	O-RING (PARKER2-389)
	11C	1	01-405-0810	SEAL
	11D	1	01-402-0670	O-RING
12	-	-	-	OUTPUT SHAFT BEARINGS
	12A	1	01-102-0190	BEARING CONE
	12B	1	01-103-0190	BEARING CUP
	12C	1	01-102-0220	BRG CONE
	12D	1	01-103-0220	BEARING CUP
13	-	-	-	HARDWARE
	13A	6	01-150-1110	HEX SOCKET HEAD CAP SCREW
	13B	20	01-150-0870	HEX HEAD CAP SCREW
	13C	20	01-166-0040	LOCKWASHER- 5/8 ZINC PL.
	13D	3	01-150-1590	FLAT HEAD HEX SOCKET CAPSCREW
	13E	20	01-150-1720	HEX HEAD CAP SCREW
	13F	20	01-166-0350	FLATWASHER - (3/4 I.D.; 1.25 O.D.) HDN
	13G	4	01-150-2112	HEX HEAD CAP SCREW
	13H	4	01-166-0360	LOCKWASHER- 3/4" MED.
14	-	-	-	PLUGS
	14A	4	01-207-0100	PIPE PLUG 3/4 NPT MAGNETIC
	14B	1	01-208-0030	HOLLOW HEX PLUG
15	-	-	-	MISCELLANEOUS
	15A	1	60-004-1922	SEAL CARRIER
	15B	1	60-005-2153	BAIL ASSY - 3-STAGE 1400 DIGGER
	15C	*	60-004-1311	SHIM - SHAFT
	15D	1	60-004-1472	LOCKING RING
	15E	1	01-160-0690	RETAINING RING
	15F	1	01-160-0826	RETAINING RING
	15G	1	60-004-1482	SPLIT RING
	15H	1	01-160-0510	RETAINING RING; INTERNAL
	15I	1	60-004-1902	ADAPTOR
	15J	1	01-201-0520	ADAPTOR SAE-12-1/8 NPT
	15K	1	01-216-0103	RELIEF VALVE - 5PSI
	15L	1	01-201-0821	
	15M	1	01-201-0820	
	16	1	01-304-1890	MOTOR



*NUMBER OF SHIMS DEPENDANT UPON DESIRED BEARING PRELOAD