



BEARING ADAPTERS

Direct Drive Bearing Housings
Typical Applications: Brush Cutting

(913) 782-1238 (Tel)
(913) 782-4206 (Fax)
Sales@Eskridgeinc.com
www.Eskridgeinc.com
FORM: PSMD-E

SHEET 1 OF 17

MODEL 28

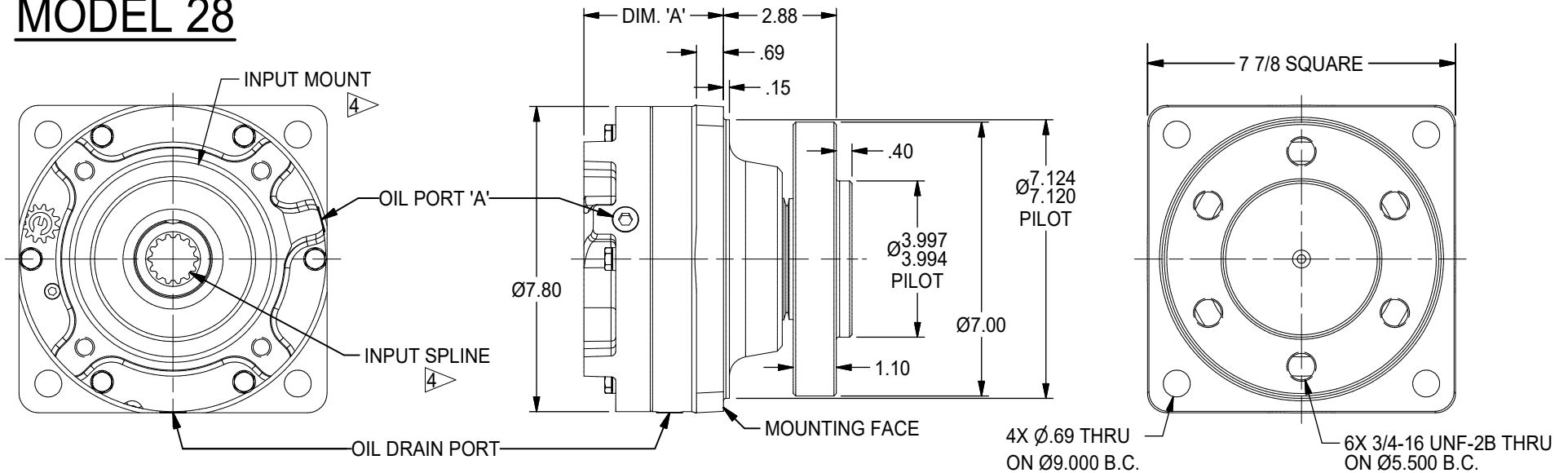

NOTES: ▷

1. EQUIPPED WITH "LOAD-N-LOCK"® SHAFT RETENTION SYSTEM.
2. OUTPUT ROTATION IS SAME DIRECTION AND SPEED AS INPUT.
3. VALUES ARE SHOWN IN INCHES.
4. SEE SHEETS 2 AND 3 FOR OPTIONS.
5. MAXIMUM OPERATING SPEED: 2,900 RPM
6. SHAFT SIZE AT OUTER BEARING: Ø2.06

OIL CAPACITIES

MOUNTING POSITION	OIL CAPACITY, INPUT MOUNTS 'A' AND 'B'	OIL CAPACITY INPUT MOUNT 'C'
HORIZONTAL	14 oz (.41 L) FILL TO OIL PORT 'A'	14 oz (.41 L) FILL TO OIL PORT 'A'
VERTICAL SPINDLE DOWN	17 oz (.50 L) FILL TO 9/16" FROM OIL PORT 'A'	17 oz (.50 L) FILL TO OIL PORT 'A'

ALL UNITS SHIPPED WITHOUT OIL
USE EP OR API GL-5 DESIGNATED LUBRICANTS
APPROXIMATE UNIT WEIGHT: 52 LB

DIMENSION 'A'

INPUT MOUNT	DIM. 'A'
OPTION 'A'	3.21
OPTION 'B'	3.21
OPTION 'C'	3.56
OPTION 'F'	3.21

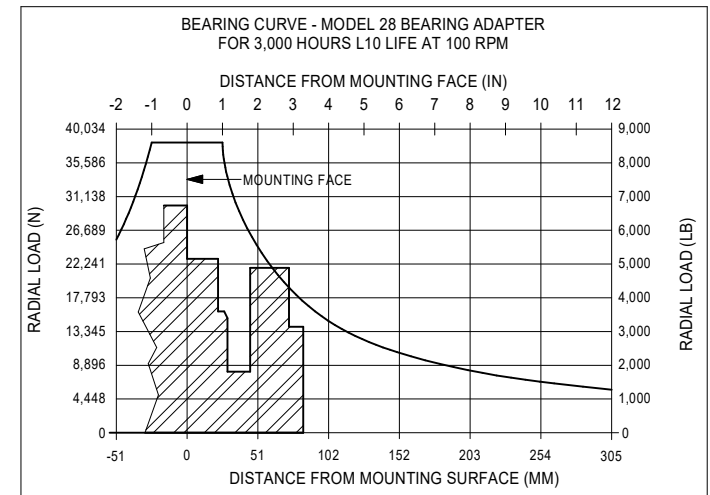

To adjust for loads and speeds other than those shown on above curve, use this formula:

$$\text{Adjusted Life (hours)} = 3000 \left(\frac{100 \text{ rpm}}{\text{Speed (Adjusted)}} \right) \times \left(\frac{\text{Load (Curve)}}{\text{Load (Adjusted)}} \right)^{10/3}$$



BEARING ADAPTERS

Direct Drive Bearing Housings
 Typical Applications: Brush Cutting

(913) 782-1238 (Tel)
 (913) 782-4206 (Fax)
Sales@Eskridgeinc.com
www.Eskridgeinc.com
 FORM: PSMD-E
 SHEET 2 OF 17

MODEL 28

INPUT MOUNTING OPTIONS

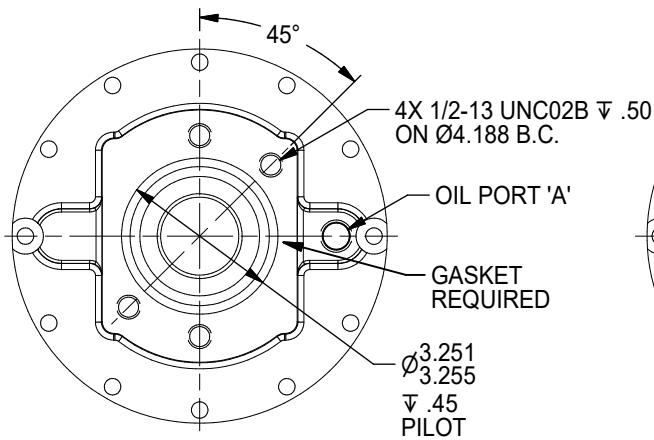

SAE 'A' 2- & Mod 4-Bolt

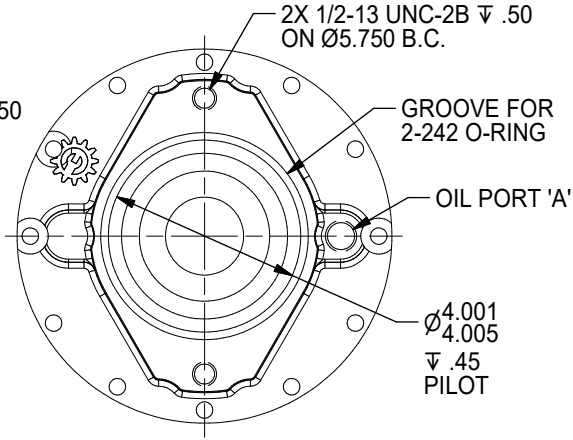

SAE 'B' 2-Bolt

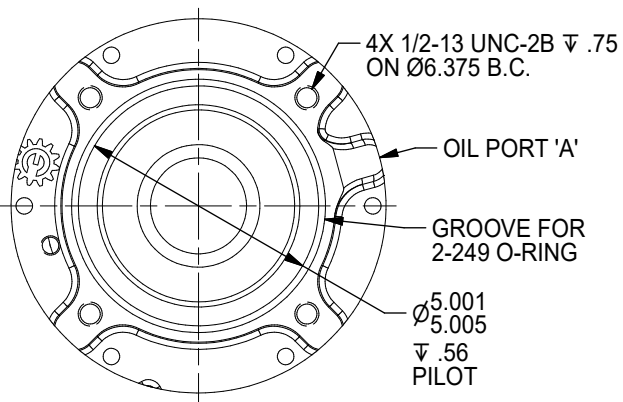

SAE 'C' 4-Bolt

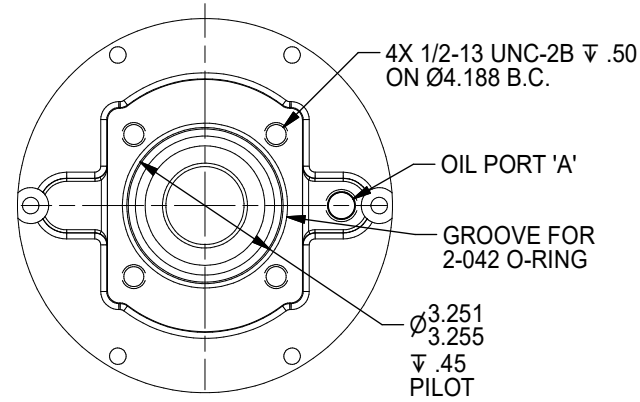

SAE 'A' 4-Bolt Danfoss

BOLT-ON SEAL GUARD

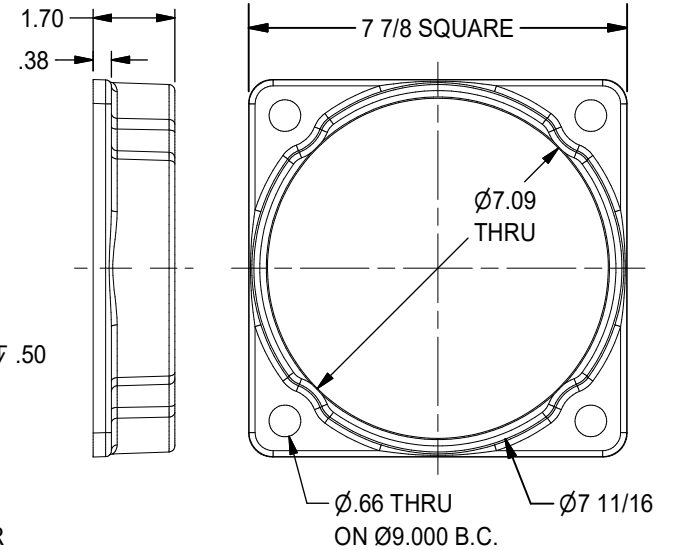

Installs from Underneath Mower Deck



BEARING ADAPTERS

Direct Drive Bearing Housings
Typical Applications: Brush Cutting

(913) 782-1238 (Tel)
(913) 782-4206 (Fax)
Sales@Eskridgeinc.com
www.Eskridgeinc.com
FORM: PSMD-E
SHEET 3 OF 17

MODEL 28

Ordering Information

Example Part Number: 28LM1S4C4-1-G

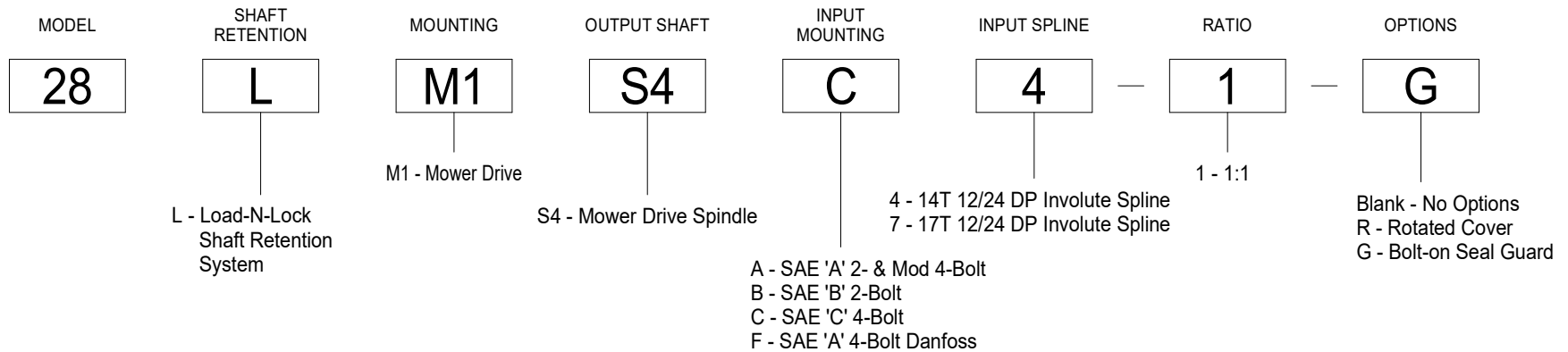



BEARING ADAPTERS

Direct Drive Bearing Housings
Typical Applications: Brush Cutting

(913) 782-1238 (Tel)
(913) 782-4206 (Fax)
Sales@Eskridgeinc.com
www.Eskridgeinc.com
FORM: PSMD-E

SHEET 4 OF 17

MODEL 50

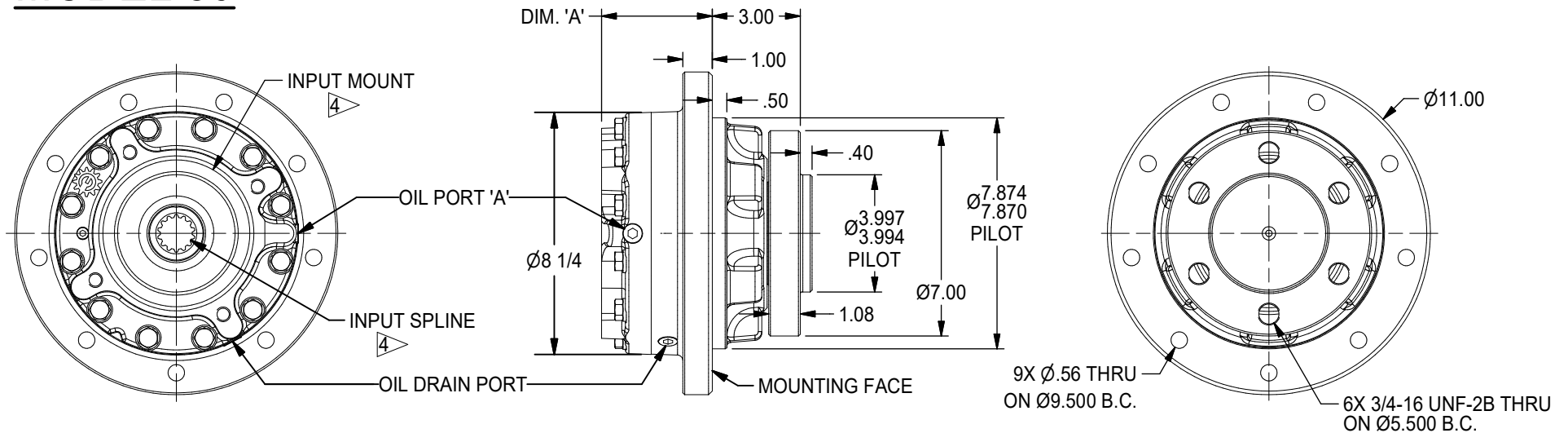

NOTES: ▷

- EQUIPPED WITH "LOAD-N-LOCK"® SHAFT RETENTION SYSTEM.
- OUTPUT ROTATION IS SAME DIRECTION AND SPEED AS INPUT.
- VALUES ARE SHOWN IN INCHES.
- SEE SHEETS 5 AND 6 FOR OPTIONS.
- MAXIMUM OPERATING SPEED: 2,600 RPM
- SHAFT SIZE AT OUTER BEARING: $\text{Ø} 2.25$

OIL CAPACITIES

MOUNTING POSITION	OIL CAPACITY, INPUT MOUNTS 'A' AND 'B'	OIL CAPACITY INPUT MOUNT 'C'
HORIZONTAL	16 oz (.47 L) FILL TO OIL PORT 'A'	16 oz (.47 L) FILL TO OIL PORT 'A'
VERTICAL SPINDLE DOWN	12 oz (.35 L) FILL TO 9/16" FROM OIL PORT 'A'	12 oz (.35 L) FILL TO OIL PORT 'A'

ALL UNITS SHIPPED WITHOUT OIL
USE EP OR API GL-5 DESIGNATED LUBRICANTS
APPROXIMATE UNIT WEIGHT: 71 LB

DIMENSION 'A'

INPUT MOUNT	DIM. 'A'
OPTION 'A'	3.42
OPTION 'B'	3.42
OPTION 'C'	3.77
OPTION 'F'	3.42

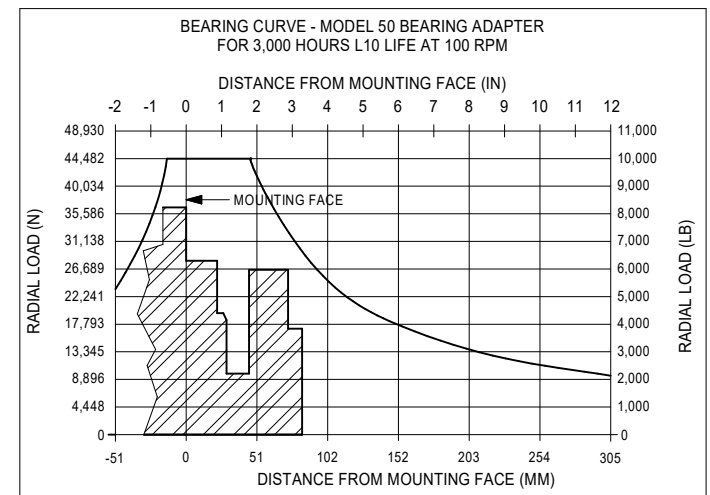

To adjust for loads and speeds other than those shown on above curve, use this formula:

$$\text{Adjusted Life (hours)} = 3000 \left(\frac{100 \text{ rpm}}{\text{Speed (Adjusted)}} \right)^3 \times \left(\frac{\text{Load (Curve)}}{\text{Load (Adjusted)}} \right)^{10/3}$$



BEARING ADAPTERS

Direct Drive Bearing Housings
Typical Applications: Brush Cutting

(913) 782-1238 (Tel)
(913) 782-4206 (Fax)
Sales@Eskridgeinc.com
www.Eskridgeinc.com
FORM: PSMD-E
SHEET 5 OF 17

MODEL 50

INPUT MOUNTING OPTIONS

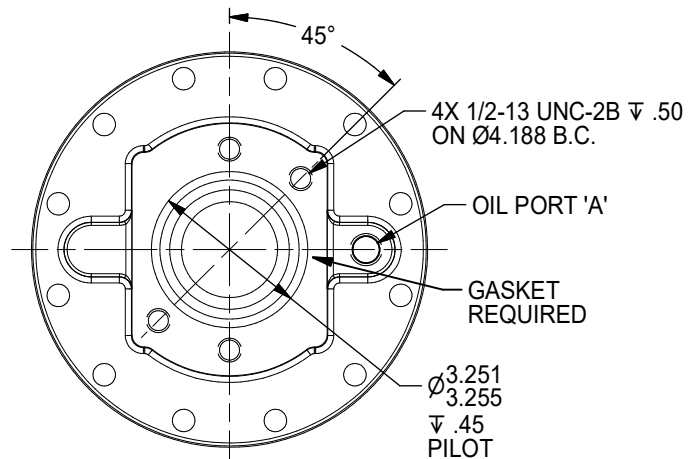

SAE 'A' 2- & Mod 4-Bolt

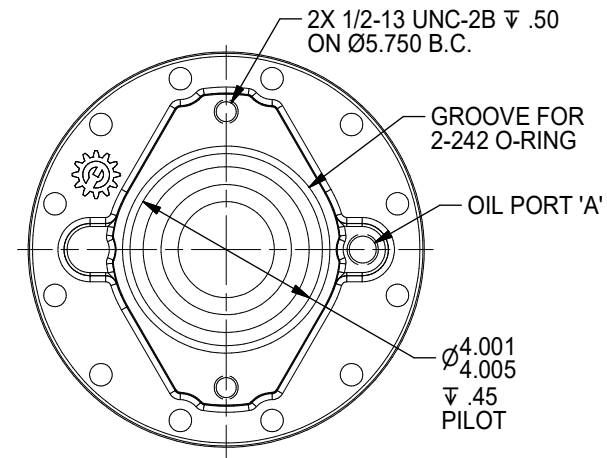

SAE 'B' 2-Bolt

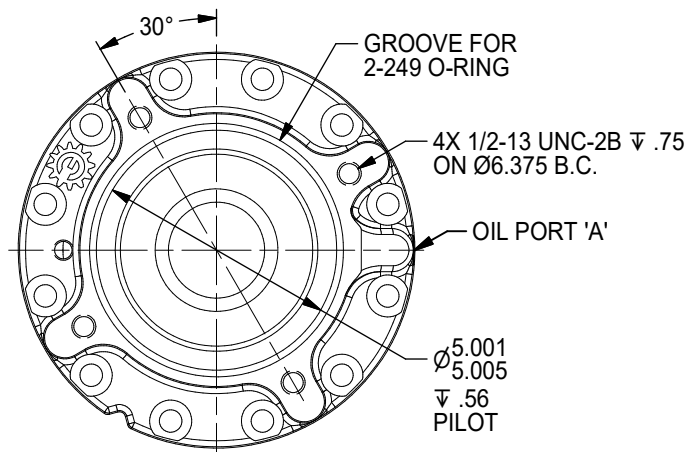

SAE 'C' 4-Bolt

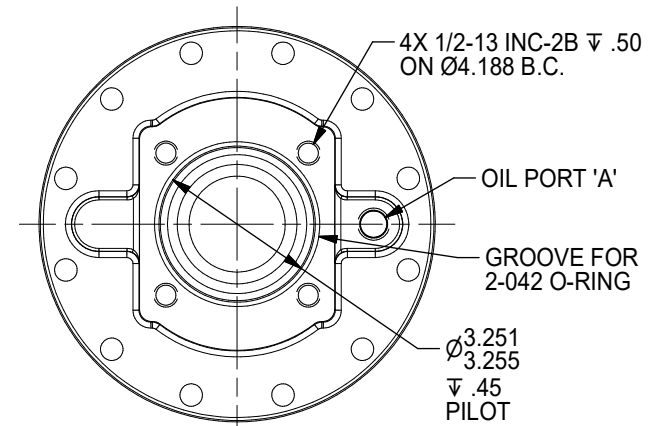

SAE 'A' 4-Bolt Danfoss



BEARING ADAPTERS

Direct Drive Bearing Housings
Typical Applications: Brush Cutting

(913) 782-1238 (Tel)
(913) 782-4206 (Fax)
Sales@Eskridgeinc.com
www.Eskridgeinc.com
FORM: PSMD-E
SHEET 6 OF 17

MODEL 50

Ordering Information

Example Part Number: 50LM1S4C4-1-R3

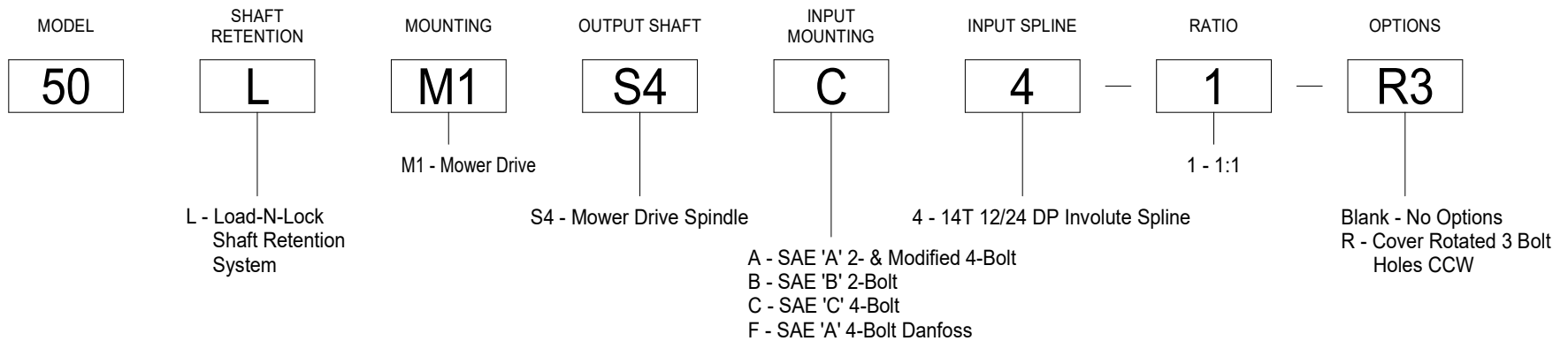



BEARING ADAPTERS

Direct Drive Bearing Housings
Typical Applications: Brush Cutting

(913) 782-1238 (Tel)
(913) 782-4206 (Fax)
Sales@Eskridgeinc.com
www.Eskridgeinc.com
FORM: PSMD-E
SHEET 7 OF 17

MODEL 70

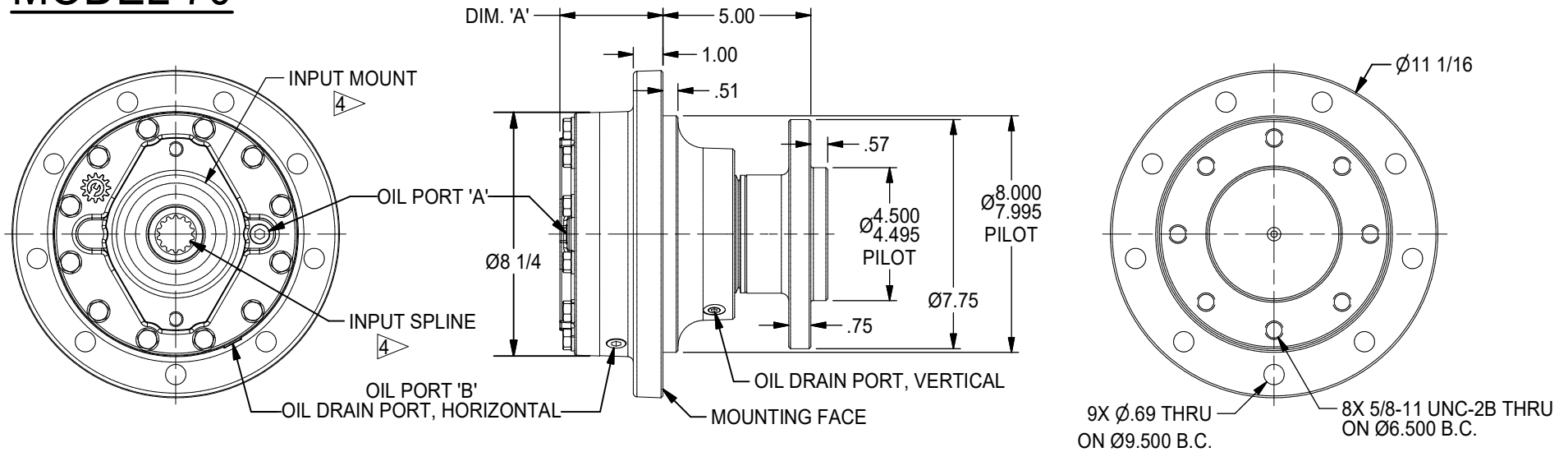

NOTES:

1. EQUIPPED WITH "LOAD-N-LOCK"® SHAFT RETENTION SYSTEM.
2. OUTPUT ROTATION IS SAME DIRECTION AND SPEED AS INPUT.
3. VALUES ARE SHOWN IN INCHES.
4. SEE SHEETS 8 AND 9 FOR OPTIONS.
5. MAXIMUM OPERATING SPEED: 2,300 RPM
6. SHAFT SIZE AT OUTER BEARING: Ø2.63

OIL CAPACITIES

MOUNTING POSITION	OIL CAPACITY
HORIZONTAL	18 oz (.53 L) FILL TO OIL PORT 'A'
VERTICAL SPINDLE DOWN	14 oz (.41 L) FILL TO OIL PORT 'B'

ALL UNITS SHIPPED WITHOUT OIL
USE EP OR API GL-5 DESIGNATED LUBRICANTS
APPROXIMATE UNIT WEIGHT: 80 LB

DIMENSION 'A'

INPUT MOUNT	DIM. 'A'
OPTION 'A'	3.48
OPTION 'B'	3.48
OPTION 'C'	3.83
OPTION 'F'	3.48

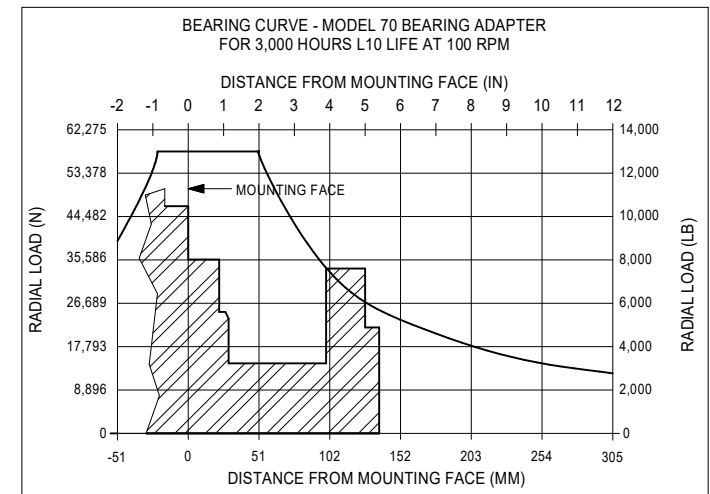

To adjust for loads and speeds other than those shown on above curve, use this formula:

$$\text{Adjusted Life (hours)} = 3000 \left(\frac{100 \text{ rpm}}{\text{Speed (Adjusted)}} \right) \times \left(\frac{\text{Load (Curve)}}{\text{Load (Adjusted)}} \right)^{10/3}$$



BEARING ADAPTERS

Direct Drive Bearing Housings
Typical Applications: Brush Cutting

(913) 782-1238 (Tel)
(913) 782-4206 (Fax)
Sales@Eskridgeinc.com
www.Eskridgeinc.com
FORM: PSMD-E
SHEET 8 OF 17

MODEL 70

INPUT MOUNTING OPTIONS

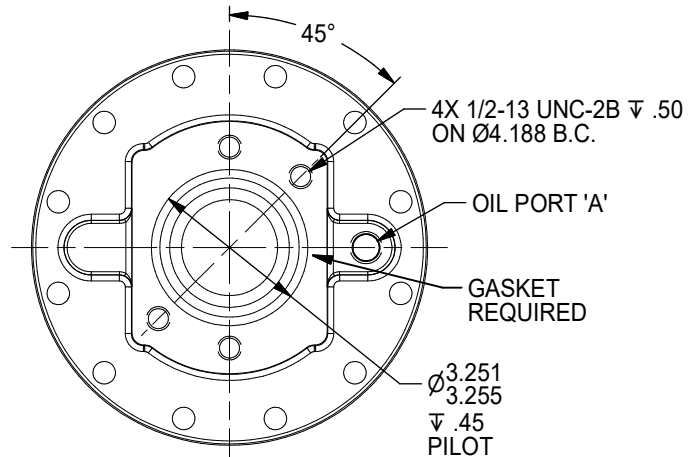

SAE 'A' 2- & Mod 4-Bolt

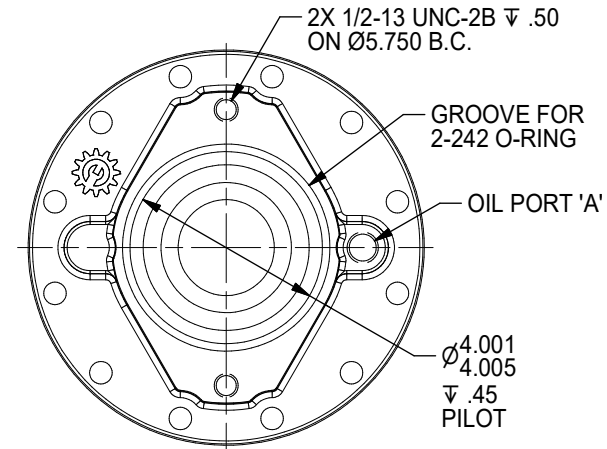

SAE 'B' 2-Bolt

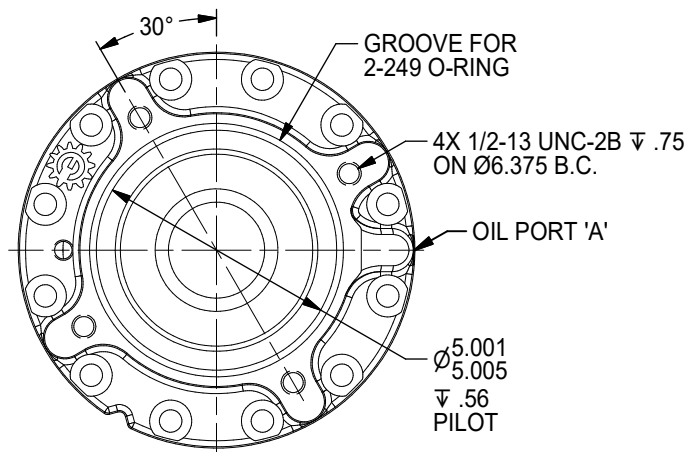

SAE 'C' 4-Bolt

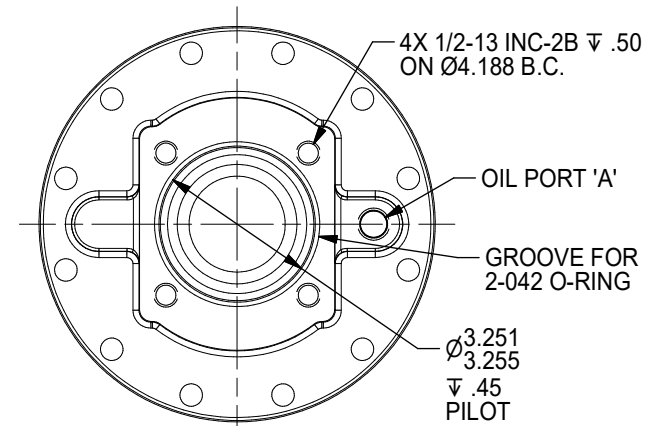

SAE 'A' 4-Bolt Danfoss



BEARING ADAPTERS

Direct Drive Bearing Housings
Typical Applications: Brush Cutting

(913) 782-1238 (Tel)
(913) 782-4206 (Fax)
Sales@Eskridgeinc.com
www.Eskridgeinc.com
FORM: PSMD-E
SHEET 9 OF 17

MODEL 70

Ordering Information

Example Part Number: **70LM1S4C4-1**

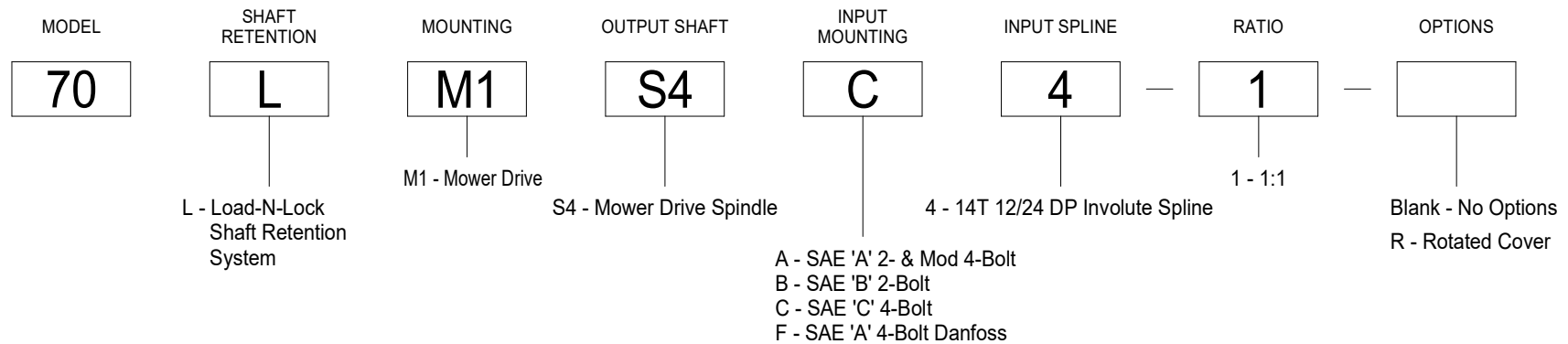



BEARING ADAPTERS

Direct Drive Bearing Housings
Typical Applications: Brush Cutting

(913) 782-1238 (Tel)
(913) 782-4206 (Fax)
Sales@Eskridgeinc.com
www.Eskridgeinc.com
FORM: PSMD-E

SHEET 10 OF 17

MODEL 70B

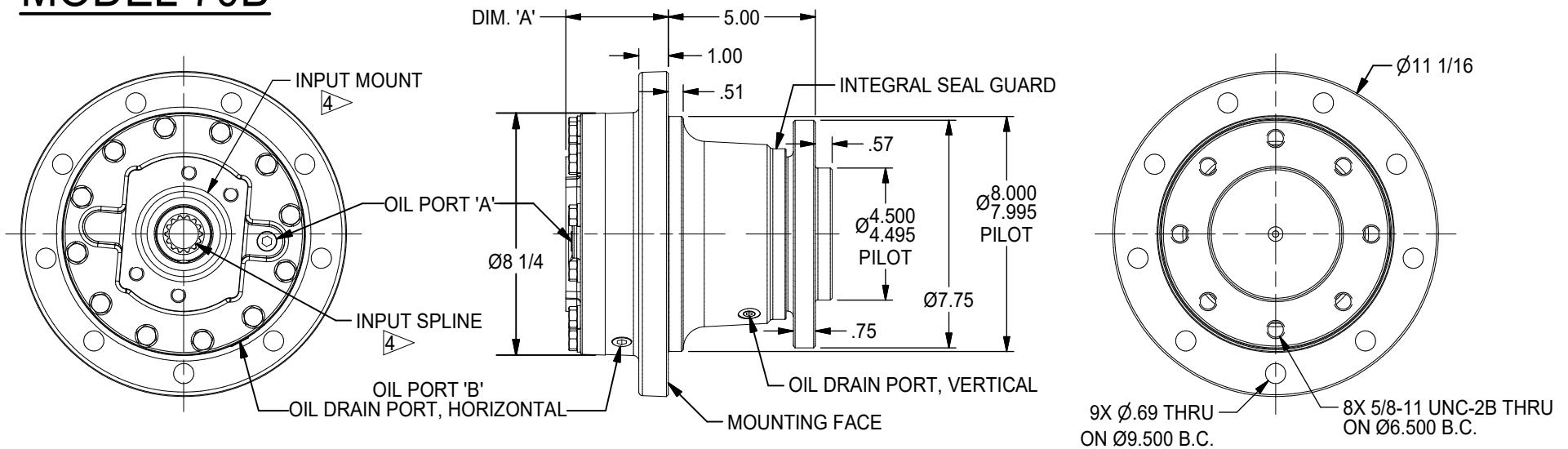

NOTES:

1. EQUIPPED WITH "LOAD-N-LOCK"® SHAFT RETENTION SYSTEM.
2. OUTPUT ROTATION IS SAME DIRECTION AND SPEED AS INPUT.
3. VALUES ARE SHOWN IN INCHES.
4. SEE SHEETS 11 AND 12 FOR OPTIONS.
5. MAXIMUM OPERATING SPEED: 2,200 RPM
6. SHAFT SIZE AT OUTER BEARING: $\text{Ø}3.00$

OIL CAPACITIES

MOUNTING POSITION	OIL CAPACITY
HORIZONTAL	20 oz (.59 L) FILL TO OIL PORT 'A'
VERTICAL SPINDLE DOWN	18 oz (.53 L) FILL TO OIL PORT 'B'

ALL UNITS SHIPPED WITHOUT OIL
USE EP OR API GL-5 DESIGNATED LUBRICANTS
APPROXIMATE UNIT WEIGHT: 85 LB

DIMENSION 'A'

INPUT MOUNT	DIM. 'A'
OPTION 'A'	3.48
OPTION 'B'	3.48
OPTION 'C'	3.83
OPTION 'F'	3.48

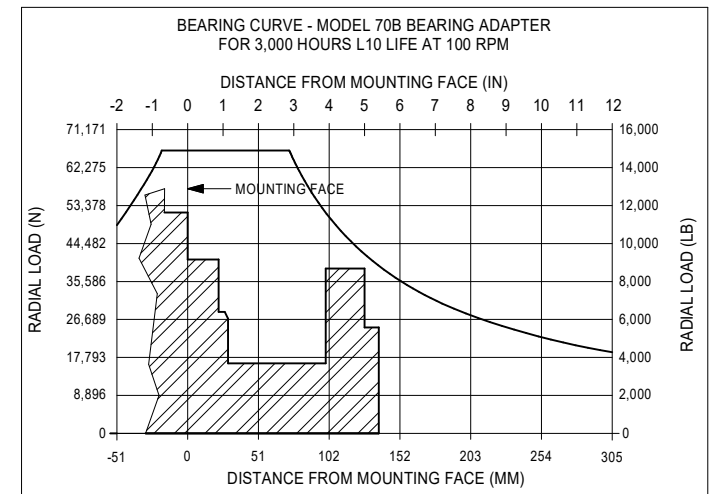

To adjust for loads and speeds other than those shown on above curve, use this formula:

$$\text{Adjusted Life (hours)} = 3000 \left(\frac{100 \text{ rpm}}{\text{Speed (Adjusted)}} \right) \times \left(\frac{\text{Load (Curve)}}{\text{Load (Adjusted)}} \right)^{10/3}$$



BEARING ADAPTERS

Direct Drive Bearing Housings
Typical Applications: Brush Cutting

(913) 782-1238 (Tel)
(913) 782-4206 (Fax)
Sales@Eskridgeinc.com
www.Eskridgeinc.com
FORM: PSMD-E
SHEET 11 OF 17

MODEL 70B

INPUT MOUNTING OPTIONS

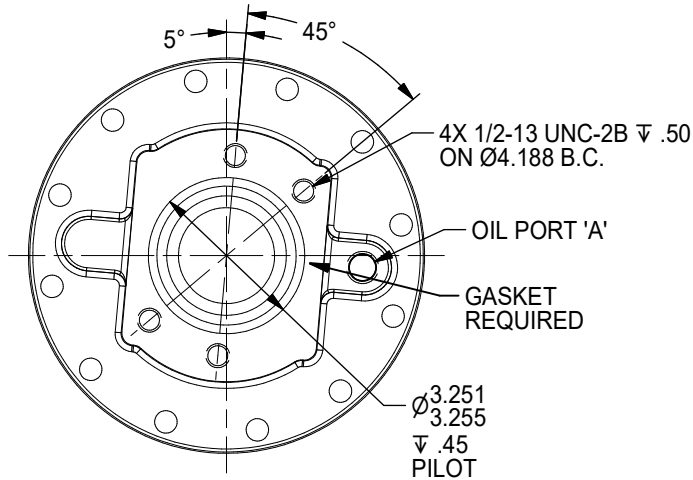

SAE 'A' 2- & Mod 4-Bolt

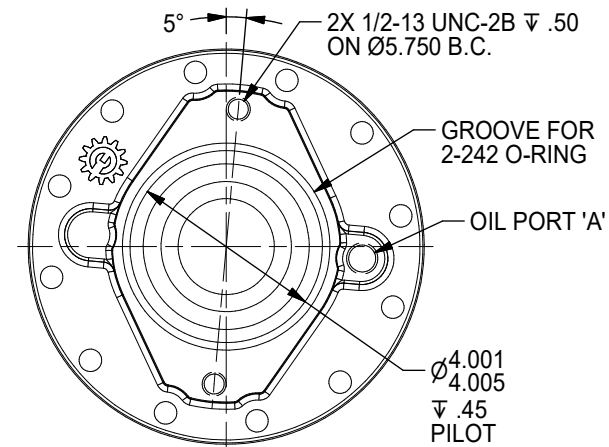

SAE 'B' 2-Bolt

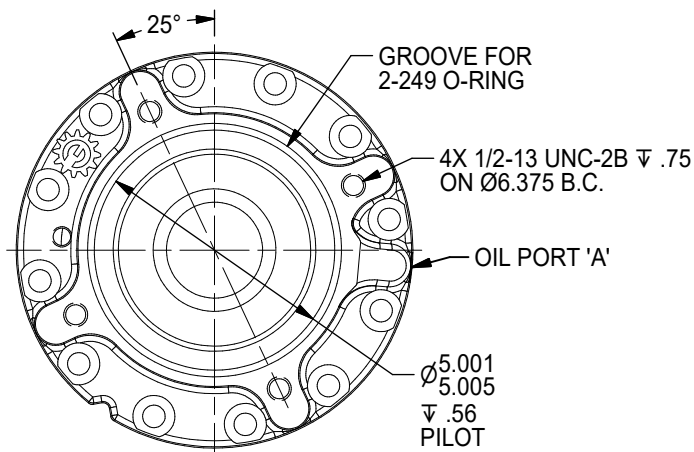

SAE 'C' 4-Bolt

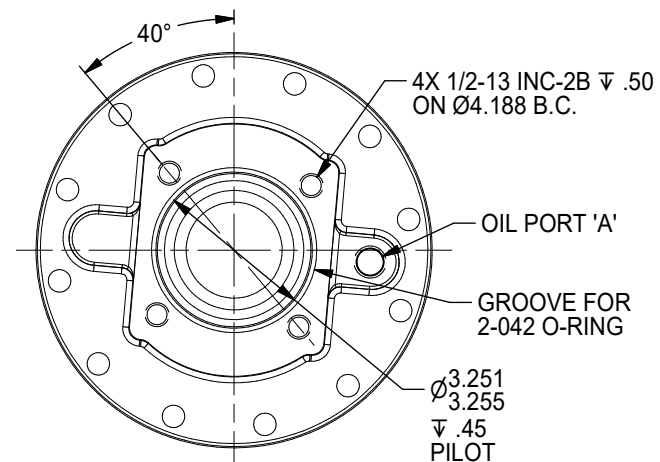

SAE 'A' 4-Bolt Danfoss



BEARING ADAPTERS

Direct Drive Bearing Housings
Typical Applications: Brush Cutting

(913) 782-1238 (Tel)
(913) 782-4206 (Fax)
Sales@Eskridgeinc.com
www.Eskridgeinc.com
FORM: PSMD-E
SHEET 12 OF 17

MODEL 70B

Ordering Information

Example Part Number: 70BLM1S4C4-1

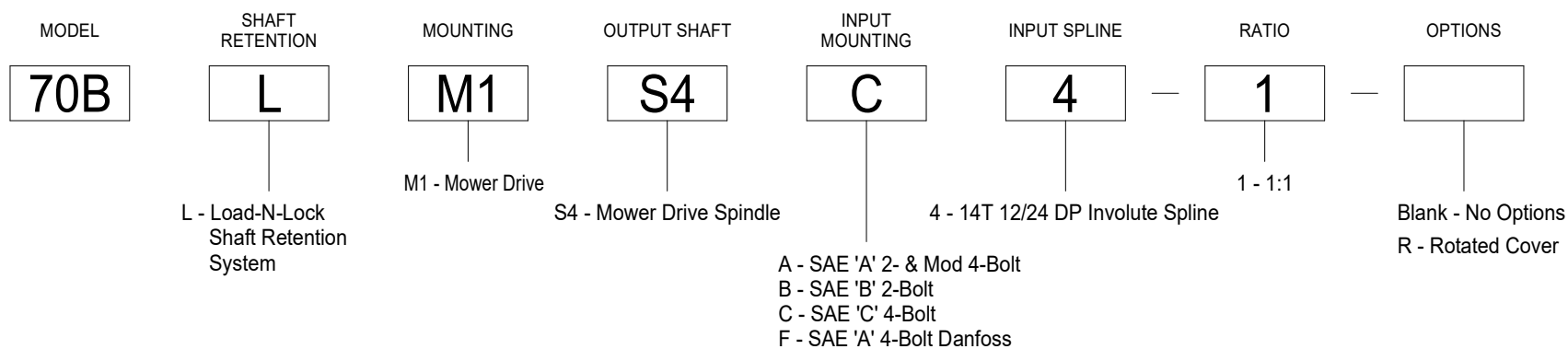



BEARING ADAPTERS

Direct Drive Bearing Housings
Typical Applications: Brush Cutting

(913) 782-1238 (Tel)
(913) 782-4206 (Fax)
Sales@Eskridgeinc.com
www.Eskridgeinc.com
FORM: PSMD-E
SHEET 13 OF 17

MODEL 132

WITH 'M1' MOUNTING OPTION

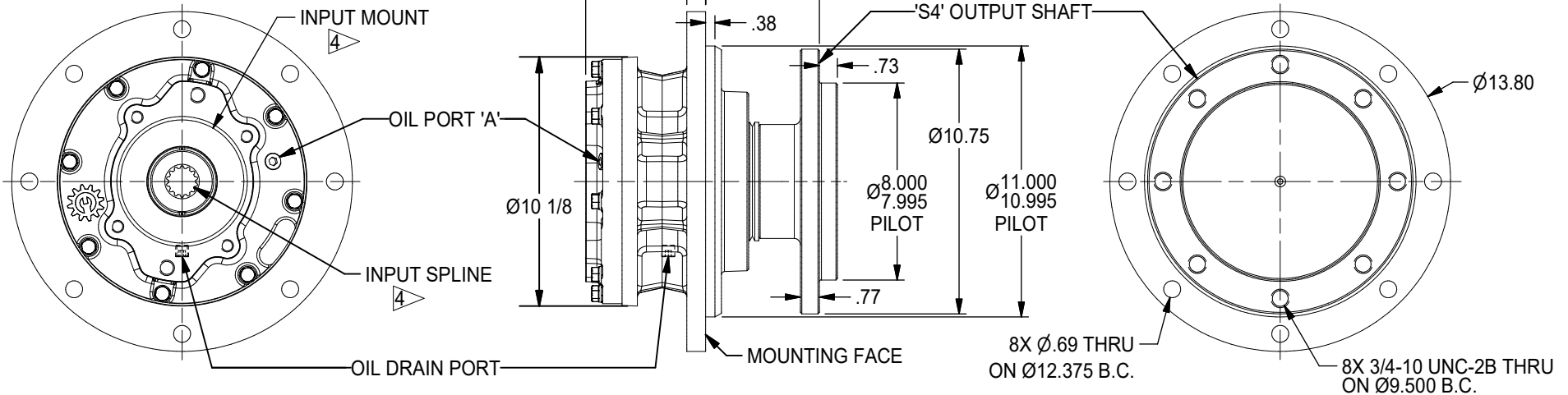

NOTES:

1. EQUIPPED WITH "LOAD-N-LOCK"® SHAFT RETENTION SYSTEM.
2. OUTPUT ROTATION IS SAME DIRECTION AND SPEED AS INPUT.
3. VALUES ARE SHOWN IN INCHES.
4. SEE SHEET 15 FOR OPTIONS.
5. MAXIMUM OPERATING SPEED: 1,900 RPM
6. SHAFT SIZE AT OUTER BEARING: Ø3.25

OIL CAPACITIES

MOUNTING POSITION	OIL CAPACITY INPUT MOUNT 'C'	OIL CAPACITY INPUT MOUNT 'D'
HORIZONTAL	17 oz (.50 L) FILL TO OIL PORT 'A'	17 oz (.50 L) FILL TO OIL PORT 'A'
VERTICAL SPINDLE DOWN	17 oz (.50 L) FILL TO 3/4" FROM OIL PORT 'A'	26 oz (.77 L) FILL TO OIL PORT 'A'

DIMENSION 'A'

INPUT MOUNT	DIM. 'A'
OPTION 'C'	4.86
OPTION 'D'	5.07

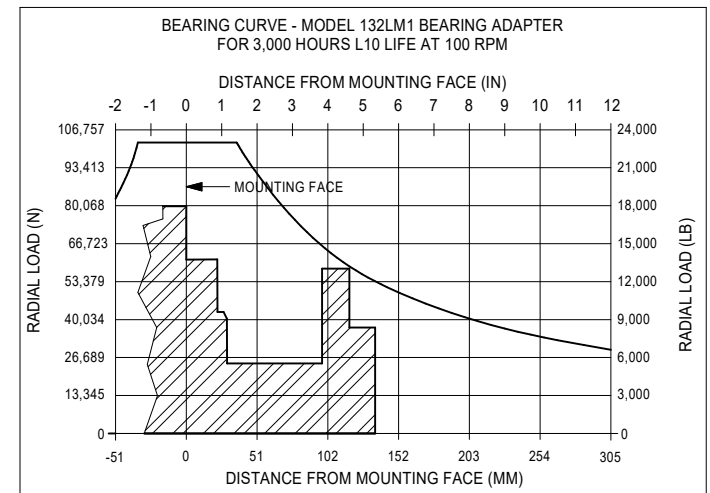

To adjust for loads and speeds other than those shown on above curve, use this formula:

$$\text{Adjusted Life (hours)} = 3000 \left(\frac{100 \text{ rpm}}{\text{Speed (Adjusted)}} \right) \times \left(\frac{\text{Load (Curve)}}{\text{Load (Adjusted)}} \right)^{10/3}$$

ALL UNITS SHIPPED WITHOUT OIL
USE EP OR API GL-5 DESIGNATED LUBRICANTS
APPROXIMATE UNIT WEIGHT: 135 LB



BEARING ADAPTERS

Direct Drive Bearing Housings
Typical Applications: Brush Cutting

(913) 782-1238 (Tel)
(913) 782-4206 (Fax)
Sales@Eskridgeinc.com
www.Eskridgeinc.com
FORM: PSMD-E
SHEET 14 OF 17

MODEL 132 WITH 'M2' MOUNTING OPTION

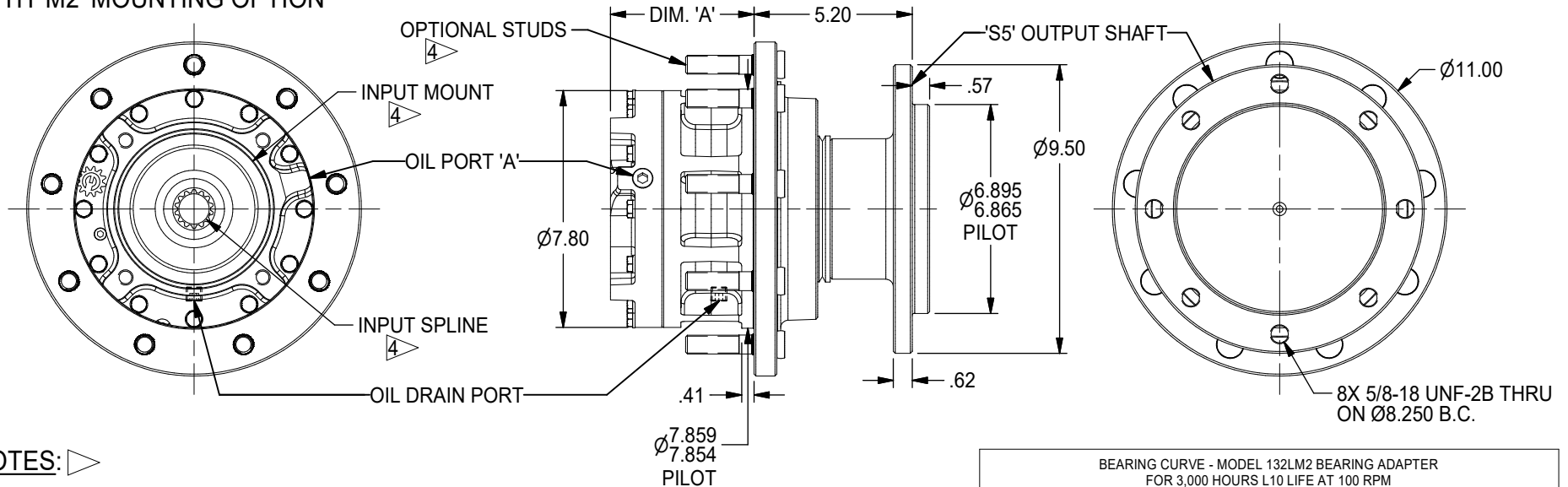

NOTES: ▷

1. EQUIPPED WITH "LOAD-N-LOCK"® SHAFT RETENTION SYSTEM.
2. OUTPUT ROTATION IS SAME DIRECTION AND SPEED AS INPUT.
3. VALUES ARE SHOWN IN INCHES.
4. SEE SHEET 15 FOR OPTIONS.
5. MAXIMUM OPERATING SPEED: 1,900 RPM
6. SHAFT SIZE AT OUTER BEARING: $\phi 3.25$

OIL CAPACITIES

MOUNTING POSITION	OIL CAPACITY INPUT MOUNT 'C'
HORIZONTAL	17 oz (.50 L) FILL TO OIL PORT 'A'
VERTICAL SPINDLE DOWN	22 oz (.50 L) FILL TO OIL PORT 'A'

DIMENSION 'A'

INPUT MOUNT	DIM. 'A'
OPTION 'C'	4.72

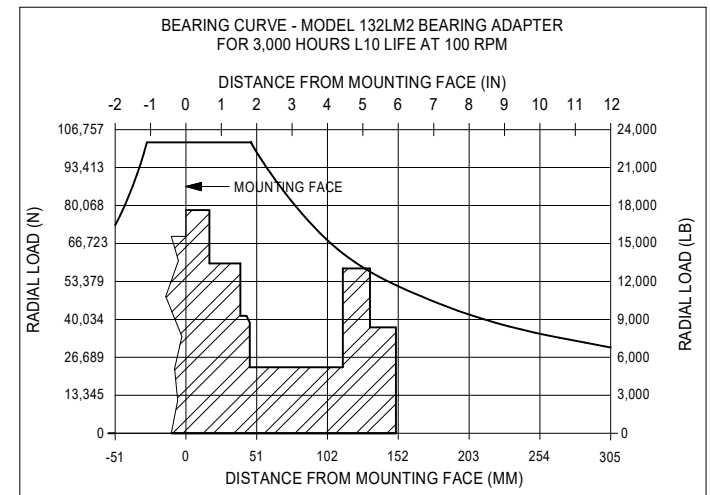

To adjust for loads and speeds other than those shown on above curve, use this formula:

$$\text{Adjusted Life (hours)} = 3000 \left(\frac{100 \text{ rpm}}{\text{Speed (Adjusted)}} \right) \times \left(\frac{\text{Load (Curve)}}{\text{Load (Adjusted)}} \right)^{10/3}$$

ALL UNITS SHIPPED WITHOUT OIL
USE EP OR API GL-5 DESIGNATED LUBRICANTS
APPROXIMATE UNIT WEIGHT: 96 LB



BEARING ADAPTERS

Direct Drive Bearing Housings
 Typical Applications: Brush Cutting

(913) 782-1238 (Tel)
 (913) 782-4206 (Fax)
Sales@Eskridgeinc.com
www.Eskridgeinc.com
 FORM: PSMD-E
 SHEET 15 OF 17

MODEL 132

Ordering Information

Example Part Number: 132LM1S4C4-1

MODEL	SHAFT RETENTION	MOUNTING	OUTPUT SHAFT	INPUT MOUNTING	INPUT SPLINE	RATIO	OPTIONS
132	L	M1	S4	C	4	1	-
	L - Load-N-Lock Shaft Retention System	M1 - Mower Drive Top Mount M2 - Mower Drive Bottom Mount	S4 - Ø10 3/4 Mower Drive Spindle S5 - Ø9 1/2 Mower Drive Spindle	C - SAE 'C' 4-Bolt* C - SAE 'C' 2- & 4-Bolt D - SAE 'D' 4-Bolt *Available only with 'M2' Mounting Option	4 - 14T 12/24 DP Involute Spline 7 - 17T 12/24 DP Involute Spline 9 - 13T 8/16 DP Involute Spline* *Available only with 'D' Input Mount	1 - 1:1	Blank - No Options R - Rotate Cover S1 - 5/8-18 x 3 Mounting Studs* S2 - 9/16-18 x 3 Mounting Studs* *Available only with 'M2' Mounting Option

INPUT MOUNTING OPTIONS

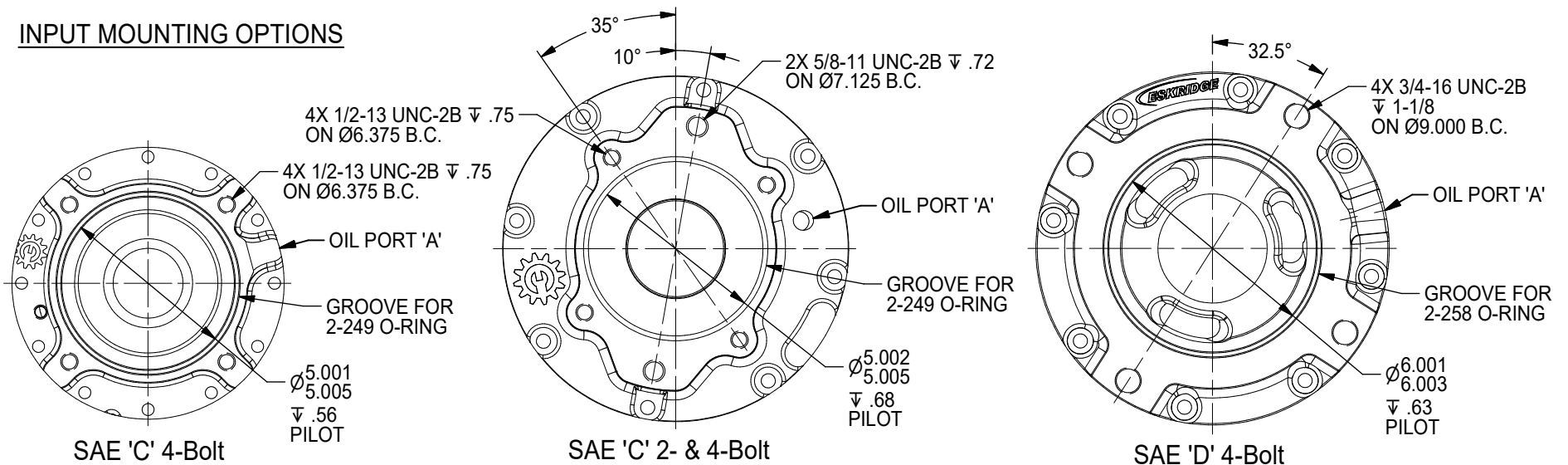



BEARING ADAPTERS

Direct Drive Bearing Housings
Typical Applications: Brush Cutting

(913) 782-1238 (Tel)
(913) 782-4206 (Fax)
Sales@Eskridgeinc.com
www.Eskridgeinc.com
FORM: PSMD-E

SHEET 16 OF 17

MODEL 252

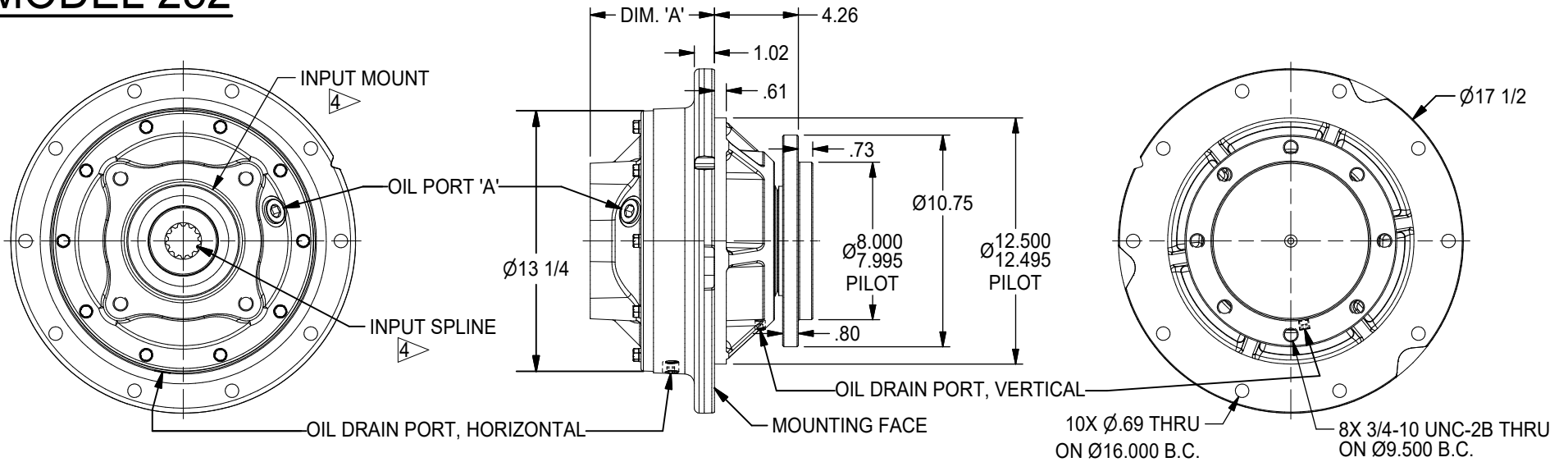

NOTES:

1. EQUIPPED WITH "LOAD-N-LOCK"® SHAFT RETENTION SYSTEM.
2. OUTPUT ROTATION IS SAME DIRECTION AND SPEED AS INPUT.
3. VALUES ARE SHOWN IN INCHES.
4. SEE SHEET 17 FOR OPTIONS.
5. MAXIMUM OPERATING SPEED: 1,600 RPM
6. SHAFT SIZE AT OUTER BEARING: Ø4.33

OIL CAPACITIES

MOUNTING POSITION	OIL CAPACITY
HORIZONTAL	4.0 PINT (1.89 L) FILL TO OIL PORT 'A'
VERTICAL SPINDLE DOWN	4.0 PINT (1.89 L) FILL TO OIL PORT 'A'

ALL UNITS SHIPPED WITHOUT OIL
USE EP OR API GL-5 DESIGNATED LUBRICANTS
APPROXIMATE UNIT WEIGHT: 240 LB

DIMENSION 'A'

INPUT MOUNT	DIM. 'A'
OPTION 'D'	6.30

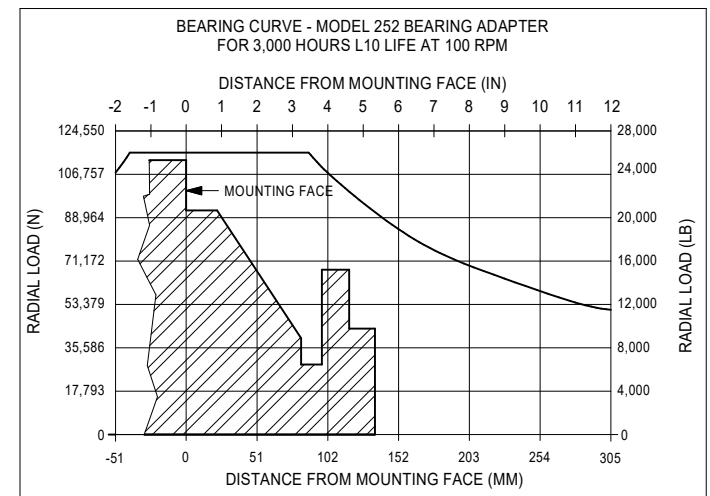

To adjust for loads and speeds other than those shown on above curve, use this formula:

$$\text{Adjusted Life (hours)} = 3000 \left(\frac{100 \text{ rpm}}{\text{Speed (Adjusted)}} \right) \times \left(\frac{\text{Load (Curve)}}{\text{Load (Adjusted)}} \right)^{10/3}$$



BEARING ADAPTERS

Direct Drive Bearing Housings
Typical Applications: Brush Cutting

(913) 782-1238 (Tel)
(913) 782-4206 (Fax)
Sales@Eskridgeinc.com
www.Eskridgeinc.com
FORM: PSMD-E
SHEET 17 OF 17

MODEL 252

Ordering Information

Example Part Number: 252LM1S4D9-1

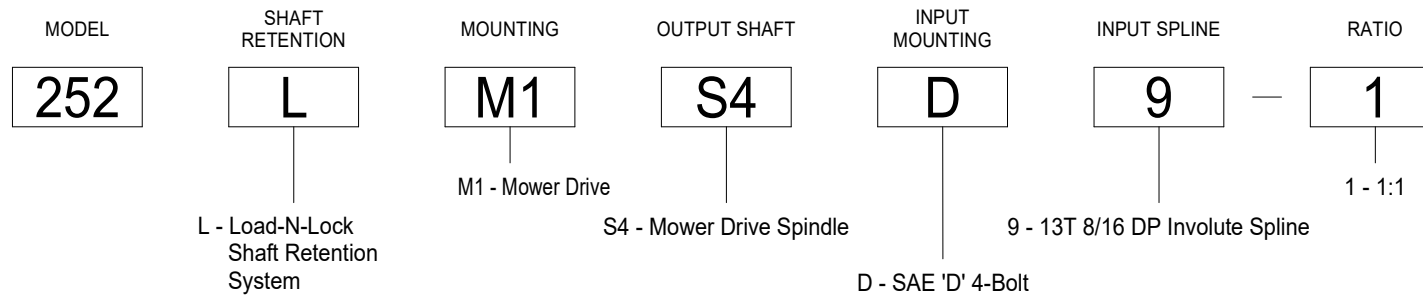

INPUT MOUNTING OPTIONS

