



1000 GEAR DRIVE - SHAFT OUTPUT

1,000,000 in-lb (112,985 N-m) Intermittent Rating 500,000 in-lb (56,492 N-m) Continuous Rating
 Typical Applications: Industrial, Marine or Mobile Equipment

(913) 782-1238 (Tel)
 (913) 782-4206 (Fax)
Sales@Eskridgeinc.com
www.Eskridgeinc.com
 FORM: PS1000L-AF
 SHEET 1 OF 5

1000 2-Stage General Dimensions Flanged 'A' Option

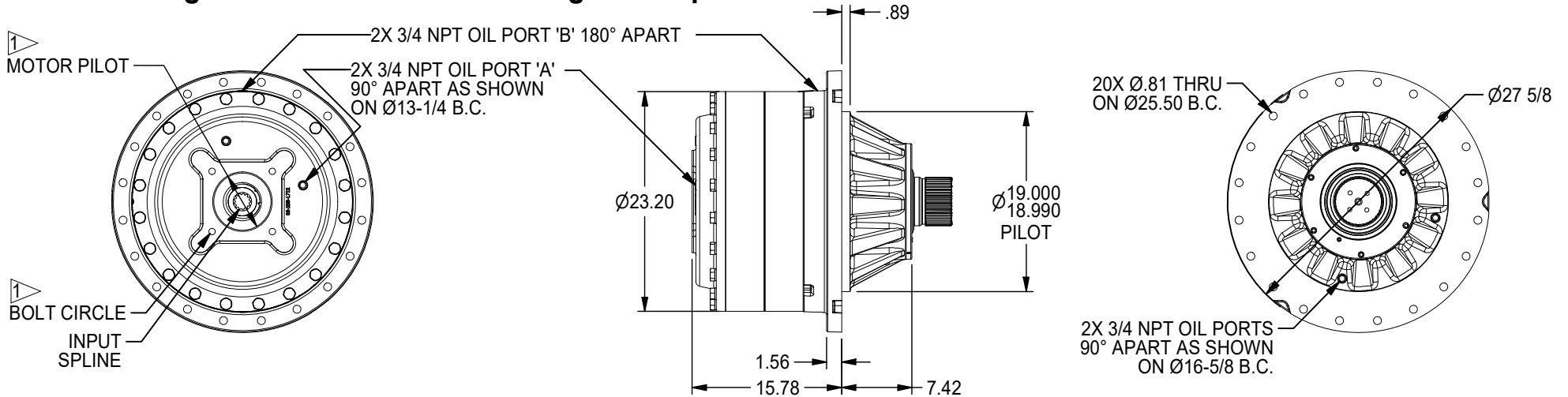

1000 2-Stage General Dimensions Flangless 'F' Option

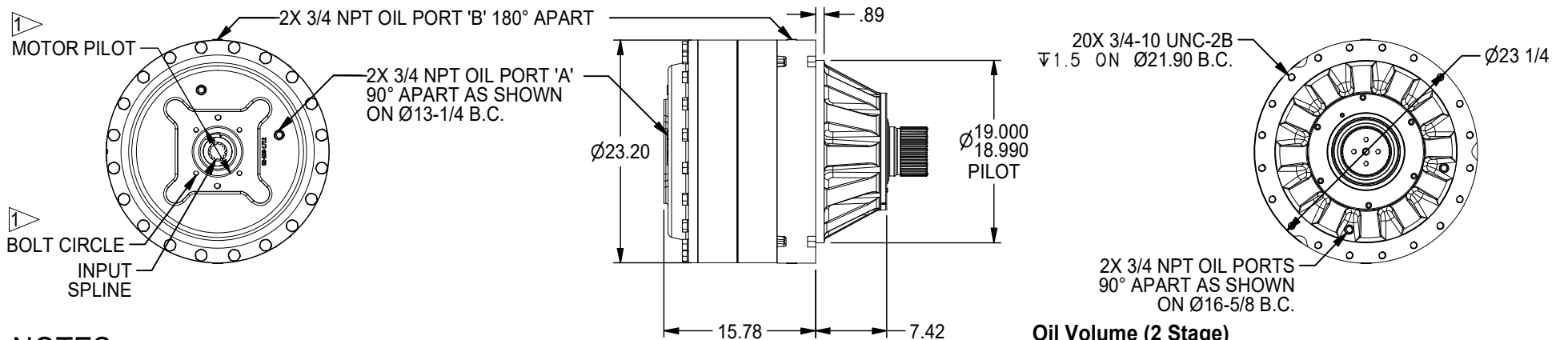

NOTES:

1. SPECIFICATIONS CALLED OUT IN MOTOR MOUNT DIMENSIONS SECTION.
2. VALUES ARE SHOWN IN INCHES.
3. OUTPUT SHAFT ROTATION SAME DIRECTION AS INPUT ROTATION.

Oil Volume (2 Stage)

| LUBRICATION QUANTITY | HORIZONTAL: | VERTICAL: PINION DOWN | VERTICAL: PINION UP |
|--------------------------------------|-------------------|-----------------------------------|---------------------|
| | 5.00 Gal | 9.50 Gal | 9.50 Gal |
| OIL FILL LEVEL (GRADE GL-5 EP 80/90) | FILL TO: PORT 'A' | FILL TO: 1.5" FROM COVER PORT 'A' | FILL TO: PORT 'B' |

All Units Shipped Without Oil



1000 GEAR DRIVE - SHAFT OUTPUT

1,000,000 in-lb (112,985 N-m) Intermittent Rating 500,000 in-lb (56,492 N-m) Continuous Rating
 Typical Applications: Industrial, Marine or Mobile Equipment

(913) 782-1238 (Tel)
 (913) 782-4206 (Fax)
Sales@Eskridgeinc.com
www.Eskridgeinc.com
 FORM: PS1000L-AF

SHEET 2 OF 5

1000 3-Stage with 254 Primary (Base dimensions identical to 2-Stage Option)

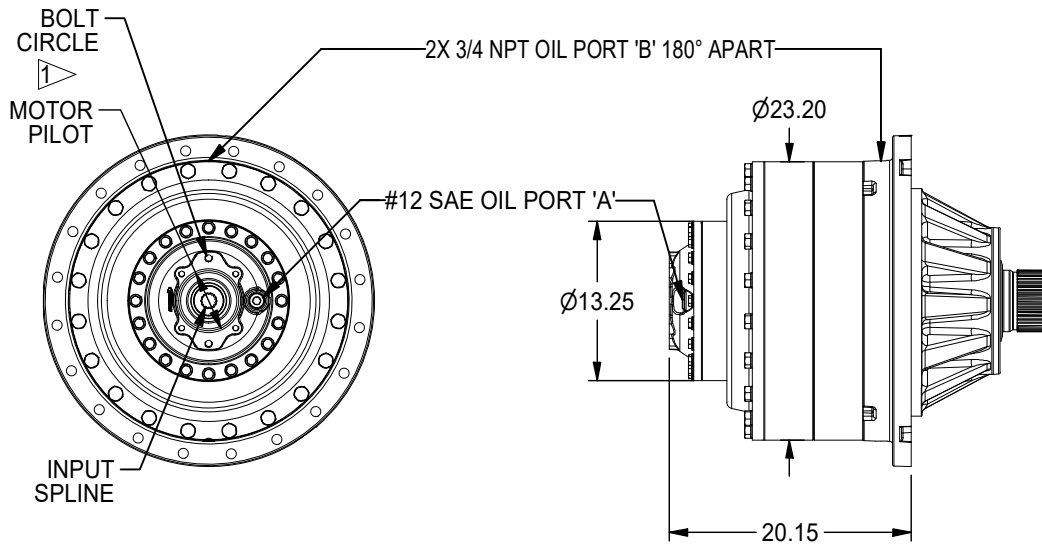

Available Ratios:

| | |
|-----|----------|
| 114 | 114.21:1 |
| 149 | 148.53:1 |
| 167 | 166.84:1 |
| 179 | 178.59:1 |
| 227 | 227.00:1 |
| 232 | 232.27:1 |
| 261 | 260.89:1 |
| 326 | 326.06:1 |
| 355 | 354.96:1 |
| 424 | 424.06:1 |
| 476 | 476.33:1 |

Input Mounting:

| |
|-------------------------------|
| SAE "A" (2 & Modified 4 Bolt) |
| SAE "B" (2 & 4 Bolt) |
| SAE "C" (2 & 4 Bolt) |
| SAE "D" (4 Bolt) |

Input Spline:

| |
|-------------------------|
| 4 (14T 12/24 DP Spline) |
| 9 (13T 8/16 DP Spline) |

Oil Volume (3 Stage with 254 Primary)

| LUBRICATION QUANTITY | ORIENTATION | HORIZONTAL: | VERTICAL: PINION DOWN | VERTICAL: PINION UP |
|--------------------------------------|-------------|-------------------|-----------------------------------|---------------------|
| | | | 5.9 Gal | 11.3 Gal |
| OIL FILL LEVEL (GRADE GL-5 EP 80/90) | | FILL TO: PORT 'A' | FILL TO: 1.5" FROM COVER PORT 'A' | FILL TO: PORT 'B' |

All Units Shipped Without Oil

(Other Ratios Available)
 Consult Eskridge Representative

1000 3-Stage with 440 Primary

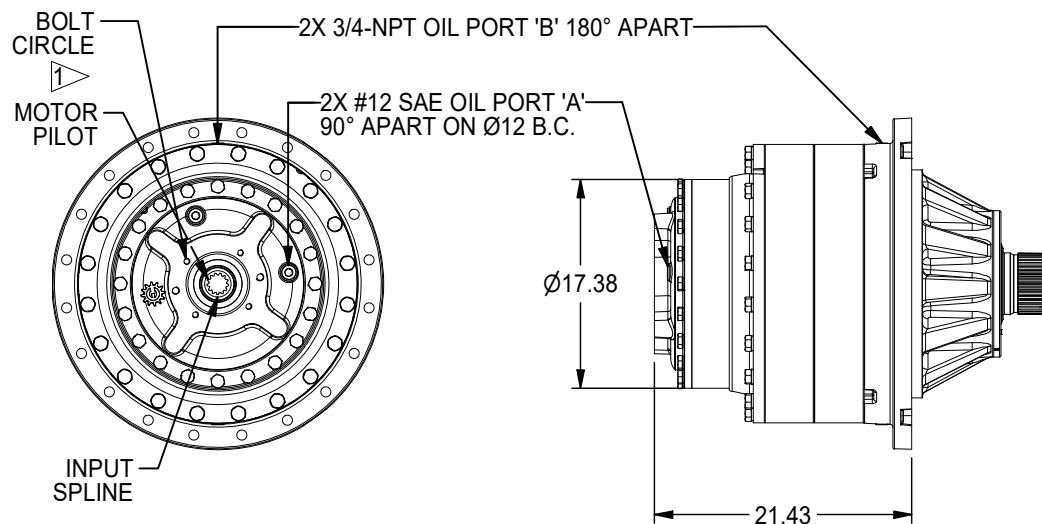

Available Ratios:

| | |
|-----|----------|
| 104 | 104.54:1 |
| 155 | 155.44:1 |
| 163 | 163.47:1 |
| 201 | 200.96:1 |
| 243 | 243.07:1 |
| 298 | 298.45:1 |
| 314 | 314.24:1 |
| 444 | 443.79:1 |

Input Mounting:

| |
|----------------------|
| SAE "C" (2 & 4 Bolt) |
| SAE "D" (4 Bolt) |
| SAE "E" (4 Bolt) |

Input Spline:

| |
|-------------------------|
| 4 (14T 12/24 DP Spline) |
| 5 (15T 8/16 DP Spline) |
| 8 (16T 8/16 DP Spline) |
| 9 (13T 8/16 DP Spline) |

Oil Volume (3 Stage with 440 Primary)

| LUBRICATION QUANTITY | ORIENTATION | HORIZONTAL: | VERTICAL: PINION DOWN | VERTICAL: PINION UP |
|--------------------------------------|-------------|-------------------|-----------------------------------|---------------------|
| | | | 5.9 Gal | 11.3 Gal |
| OIL FILL LEVEL (GRADE GL-5 EP 80/90) | | FILL TO: PORT 'A' | FILL TO: 1.5" FROM COVER PORT 'A' | FILL TO: PORT 'B' |

All Units Shipped Without Oil

(Other Ratios Available)
 Consult Eskridge Representative

NOTES:

- SPECIFICATIONS CALLED OUT IN MOTOR MOUNT DIMENSIONS SECTION.
- 16T NOT AVAILABLE ON 201:1 AND 314:1 RATIOS.



1000 GEAR DRIVE - SHAFT OUTPUT

1,000,000 in-lb (112,985 N-m) Intermittent Rating 500,000 in-lb (56,492 N-m) Continuous Rating
Typical Applications: Industrial, Marine or Mobile Equipment

(913) 782-1238 (Tel)
(913) 782-4206 (Fax)
Sales@Eskridgeinc.com
www.Eskridgeinc.com
FORM: PS1000L-AF
SHEET 3 OF 5

Output Shaft Options *Values are shown as inches.*

D1 - 40T 8/16 DP Spline

Adapter Hub Available
Part Number: 60-004-4042
Retainer Kit: 60-018-0901

See Hubs and Pinions Technical
Data Sheet for details.

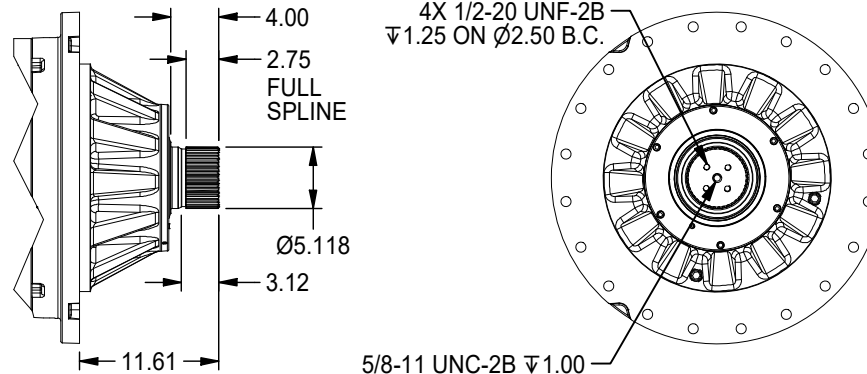

D2 - $\text{Ø}5.125$ X 1.50 X 5 Keyway

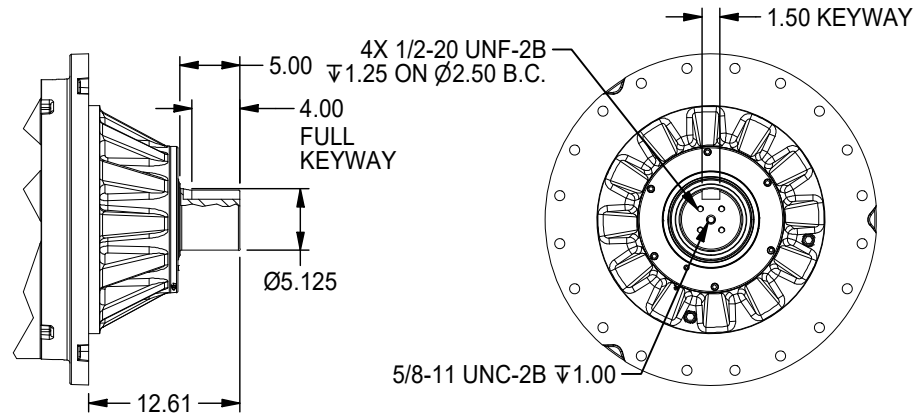

D3 - Long 40T 8/16 DP Spline

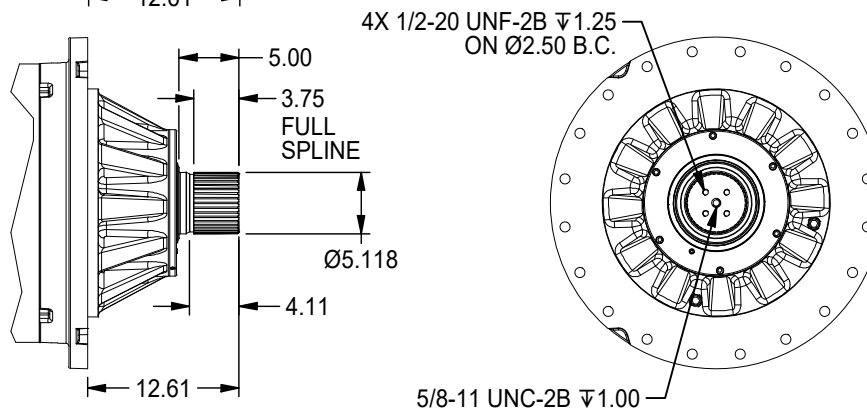



1000 GEAR DRIVE - SHAFT OUTPUT

1,000,000 in-lb (112,985 N-m) Intermittent Rating 500,000 in-lb (56,492 N-m) Continuous Rating
 Typical Applications: Industrial, Marine or Mobile Equipment

(913) 782-1238 (Tel)
 (913) 782-4206 (Fax)
Sales@Eskridgeinc.com
www.Eskridgeinc.com
 FORM: PS1000L-AF

SHEET 4 OF 5

Performance Ratings

Maximum Intermittent Output Torque: 1,000,000 in-lb (113,000 N-m)
 Continuous Output Torque: 500,000 in-lb (56,500 N-m)
 Maximum Input Speed: 4,000 RPM
 Maximum Operating Ambient Temperature: 110° F (43° C)
 Minimum Operating Ambient Temperature: -20° F (-28° C)

Consult your Eskridge representative to determine ratings for your specific application or configuration

Motor Mount Dimensions

| PILOT DIMENSIONS | BOLT CIRCLE |
|----------------------|--|
| SAE 'A' Ø3.250/3.254 | 2 & 4X 1/2-13 UNC-2B ∇5/8 ON Ø4.188 B.C. |
| SAE 'B' Ø4.001/4.005 | 2X 1/2-13 UNC-2B ∇.50 ON Ø5.75 B.C. |
| SAE 'C' Ø5.001/5.004 | 4X 1/2-13 UNC-2B ∇1 ON Ø6.375 B.C. 2X 5/8-11 UNC-2B ∇1 ON Ø7.125 B.C. |
| SAE 'D' Ø6.000/6.004 | 4X 3/4-10 UNC-2B ∇1 ON Ø9.000 B.C. |
| SAE 'E' Ø6.501/6.505 | 4X 3/4-10 UNC-2B ∇1 ON Ø12.500 B.C. |

Approximate Unit Weight

Single Stage: 1,350 - 1,425 lb (614-648 kg)
 Two Stage: 1,350 lb (614 kg)
 Three Stage: 1,700 lb (771 kg)

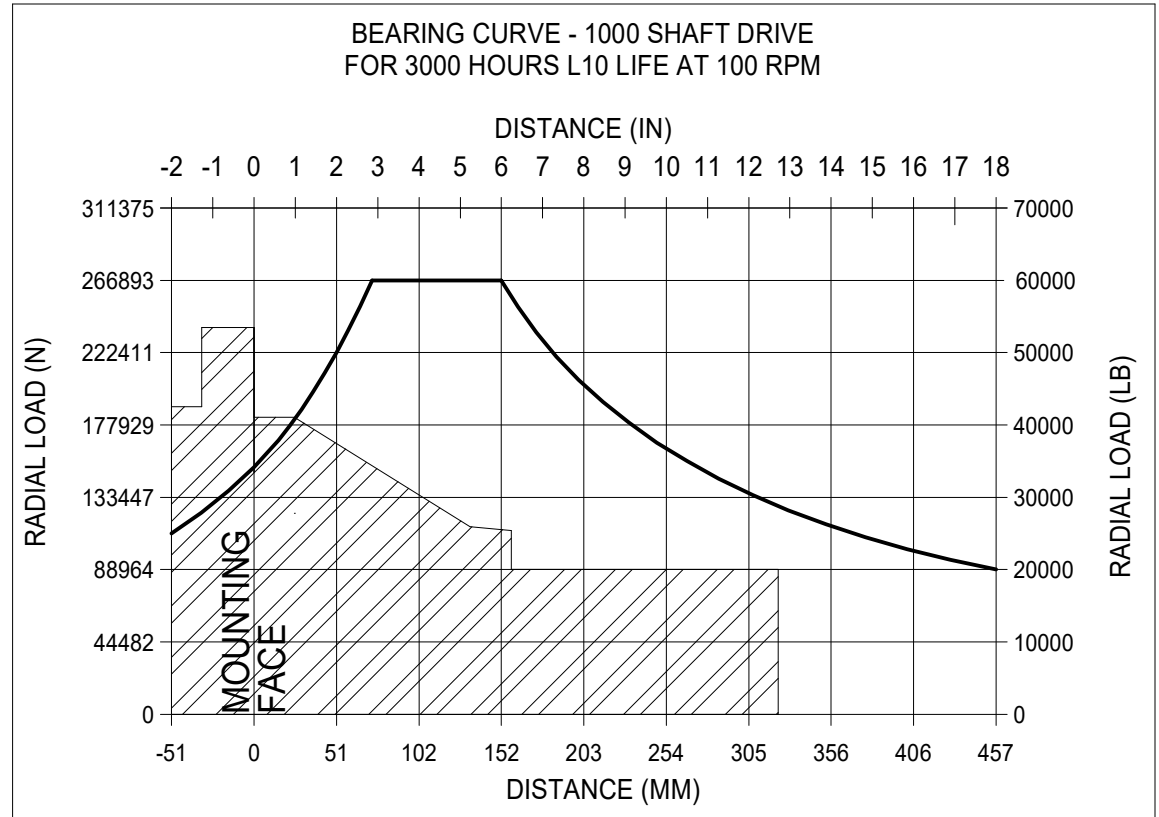

To adjust for loads and speeds other than those shown on above curve, use this formula:

$$\text{Adjusted Life (hours)} = 3000 \left(\frac{100 \text{ rpm}}{\text{Speed (Adjusted)}} \right) \times \left(\frac{\text{Load (Curve)}}{\text{Load (Adjusted)}} \right)^{10/3}$$



1000 GEAR DRIVE - SHAFT OUTPUT

1,000,000 in-lb (112,985 N-m) Intermittent Rating 500,000 in-lb (56,492 N-m) Continuous Rating
 Typical Applications: Industrial, Marine or Mobile Equipment

(913) 782-1238 (Tel)
 (913) 782-4206 (Fax)
Sales@Eskridgeinc.com
www.Eskridgeinc.com
 FORM: PS1000L-AF

SHEET 5 OF 5

Ordering Information

Example Part Number: 1000LAD1D9-76Z

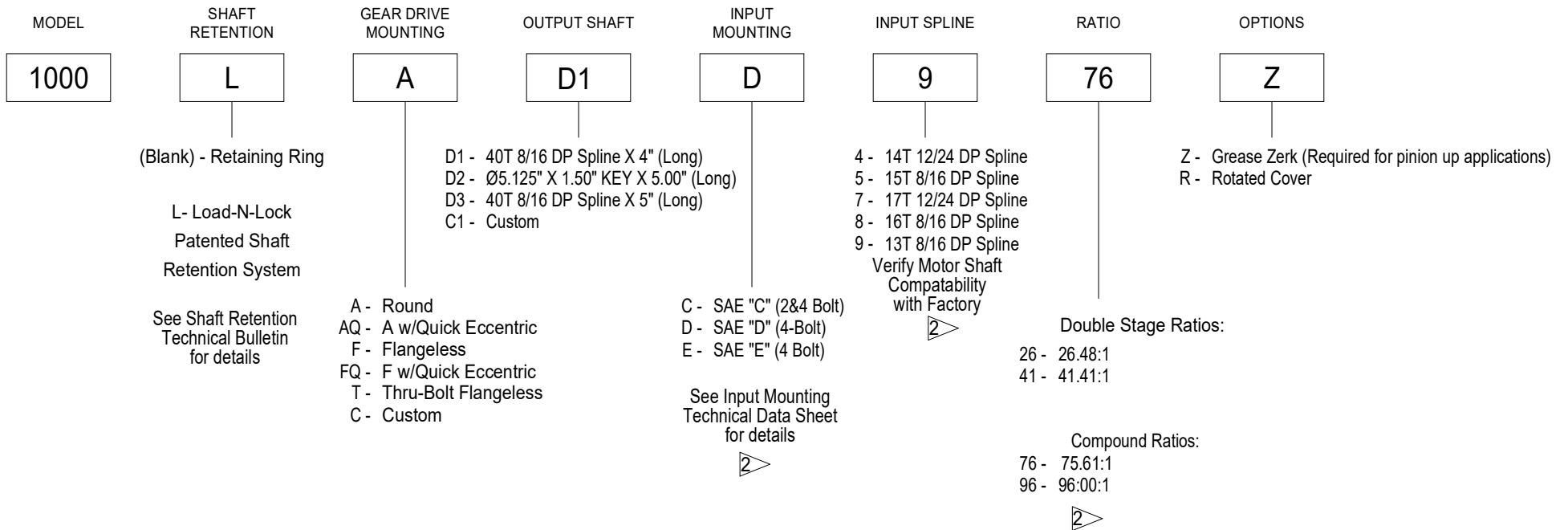

NOTES:

1. TWO STAGE RATIO GEARBOX SHOWN IN EXAMPLE.
2. THREE STAGE INPUT MOUNTING, INPUT SPLINE AND RATIOS ARE SHOWN ON PAGE 2.