

# ESKRIDGE MODEL 50L

## DOUBLE PLANETARY

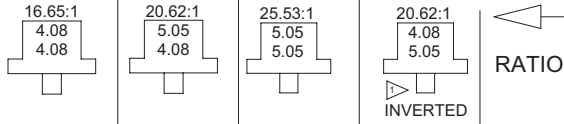

EFFECTIVE  
FROM: S/N 38000 11-01-98  
TO: (CURRENT)

|             |             |             |             | QTY. | ITEM | DESCRIPTION                                 |
|-------------|-------------|-------------|-------------|------|------|---|
| PART NUMBER | PART NUMBER | PART NUMBER | PART NUMBER |      |      |   |
|             |             |             |             | 1    | 1    | A ROUND FLANGE (NO ZERK)                    |
|             |             |             |             |      |      | E RECTANGULAR FLANGE (NO ZERK)              |
|             |             |             |             |      |      | F FLANGLESS (NO ZERK)                       |
|             |             |             |             |      |      | C CUSTOM                                    |
|             |             |             |             |      |      | D1 2"DIA SHAFT-3/8" KEYWAY                  |
|             |             |             |             |      |      | D2 23T 12/24 D.P. SPLINE                    |
|             |             |             |             |      |      | D3 2-1/8"DIA SHAFT-1/2" KEYWAY              |
|             |             |             |             |      |      | D4 2"DIA SHAFT-1/2" KEYWAY                  |
|             |             |             |             |      |      | F2 2"DIA X .50" KEY (INTERNAL)              |
|             |             |             |             |      |      | H2 2"HEX SHAFT-13/16 DIA.HOLE               |
|             |             |             |             |      |      | H3 2-5/8"HEX SHAFT-13/16 DIA.HOLE           |
|             |             |             |             |      |      | S1 7" SPINDLE 50L (5) X 1/2-13              |
|             |             |             |             |      |      | S2 7" SPINDLE 50L (5) X .610 DIA THRU HOLES |
|             |             |             |             |      |      | C1 SHAFT-CUSTOM                             |
|             |             |             |             | 1    | 3    | A COVER-SAE 'A'                             |
|             |             |             |             |      |      | B COVER-SAE 'B' 2-BOLT                      |
|             |             |             |             |      |      | C COVER-SAE 'C' 4-BOLT                      |
|             |             |             |             |      |      | K COVER-SAE 'C' 2-BOLT                      |
|             |             |             |             | 1    | 4    | 2 INPUT GEAR 13T 16/32 DP SPLINE            |
|             |             |             |             |      |      | 3 INPUT GEAR SAE 1"-6B SPLINE               |
|             |             |             |             |      |      | 4 INPUT GEAR 14T 12/24 DP SPLINE            |
|             |             |             |             |      |      | 5 INPUT GEAR 15T 16/32 DP SPLINE            |
|             |             |             |             |      |      | 6 INPUT GEAR 1" DIA X .25 KEY               |
|             |             |             |             | 1    | 5    | CARRIER ASSEMBLY                            |
|             |             |             |             |      |      | CARRIER                                     |
|             |             |             |             |      |      | PLANET GEAR                                 |
|             |             |             |             |      |      | PLANET SHAFT                                |
|             |             |             |             |      |      | PLANET BEARING                              |
|             |             |             |             |      |      | PLANET THRUST WASHER                        |
|             |             |             |             |      |      | ROLL PIN 3/16 X 7/8                         |
|             |             |             |             |      |      | SUN GEAR                                    |
|             |             |             |             | 1    | 7    | CARRIER ASSEMBLY                            |
|             |             |             |             |      |      | CARRIER                                     |
|             |             |             |             |      |      | PLANET GEAR                                 |
|             |             |             |             |      |      | PLANET SHAFT                                |
|             |             |             |             |      |      | PLANET BEARING                              |
|             |             |             |             |      |      | PLANET THRUST WASHER                        |
|             |             |             |             |      |      | ROLL PIN 1/8 X 1                            |
|             |             |             |             |      |      | RING GEAR                                   |
|             |             |             |             |      |      | CARRIER THRUST WASHER                       |
|             |             |             |             |      |      | INPUT THRUST WASHER                         |
|             |             |             |             |      |      | SEAL KIT (1 SEAL, 2 O-RINGS)                |
|             |             |             |             |      |      | SEAL-SHAFT                                  |
|             |             |             |             |      |      | O-RING                                      |
|             |             |             |             |      |      | BEARING CONE (OUTER)                        |
|             |             |             |             |      |      | BEARING CUP (OUTER)                         |
|             |             |             |             |      |      | BEARING CONE (INNER)                        |
|             |             |             |             |      |      | BEARING CUP (INNER)                         |
|             |             |             |             |      |      | HEX CAPSCREW 7/16-20 GR8                    |
|             |             |             |             |      |      | LOCKWASHER 7/16 MED                         |
|             |             |             |             |      |      | PIPE PLUG-MAGNETIC 3/8 NPT-SOC HD           |
|             |             |             |             |      |      | GREASE FITTING (OPTIONAL) STR. 1/8 NPT      |
|             |             |             |             |      |      | AIR VENT 3/8 NPT (OPTIONAL)                 |
|             |             |             |             |      |      | PIPE PLUG (C & K COVER ONLY) 1/8 NPT        |
|             |             |             |             |      |      | SHIM(S)                                     |
|             |             |             |             |      |      | SPLIT RING (MATCHING HALVES)                |
|             |             |             |             |      |      | LOCK RING                                   |

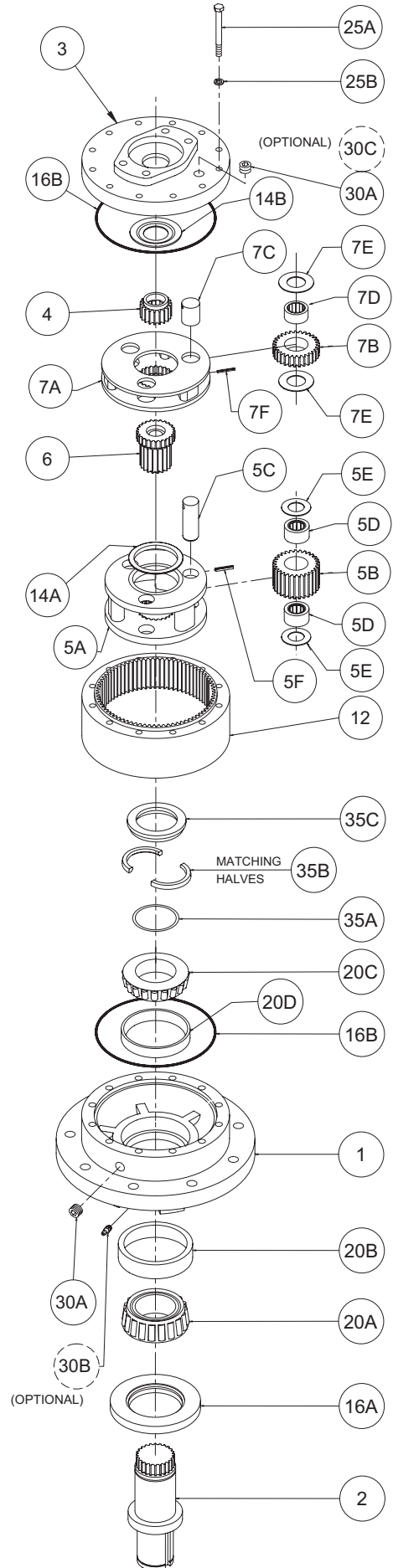

NOTES:

1 INVERTED RATIO SUNGEAR IS NOT COUNTERBORED FOR CODE 4 INPUT. MOTOR COMPATIBILITY MUST BE VERIFIED.

2 FOR GREASE ZERK OPTION, ADD 'Z' SUFFIX TO BASE P/N

\* BEARING PRELOAD DETERMINES QUANTITY OF SHIMS.

S2 - SHAFT REQUIRES STUDS (QTY 5) PART NO. 01-164-0040.