

105E Double Stage Exploded View Drawing

MODEL E 105			DOUBLE PLANETARY						
RATIO →			19.54:1	26.52:1	**	**	36.00:1	**	
EFFECTIVE FOR: FROM S/N 55013, 6/3/02 TO CURRENT			4.42 4.42	4.42 6.00	7.50 4.42	7.50 6.00	6.00 6.00	7.50 6.00	
ITEM	QTY	DESCRIPTION	PART NO.	PART NO.	PART NO.	PART NO.	PART NO.	PART NO.	
1	1	CASE-E100 (STD)	86-004-3602	86-004-3602	86-004-3602	86-004-3602	86-004-3602	86-004-3602	
2	1	CARRIER (SEC)	83-004-1262	83-004-1232	83-004-1262	83-004-1232	83-004-1232	83-004-1232	
3	1	CARRIER (PRI)	13-004-1032	13-004-1032	13-004-1032	13-004-1032	13-004-1032	13-004-1032	
4	1	THRUST WASHER- SECONDARY	81-004-2711	81-004-2711	-	-	81-004-2711	-	
5	2	THRUST WASHER- SECONDARY	-	-	81-004-2711	81-004-2711	-	81-004-2711	
5	1	PLATE-BEARING RETAINER	86-004-1002	86-004-1002	86-004-1002	86-004-1002	86-004-1002	86-004-1002	
COVER	6	1	SAE 'A' 2 AND MOD 4 BOLT	13-004-1192	13-0041192	13-0040-1222		13-004-1192	13-004-1222
			SAE 'A' 2 AND MOD 4 BOLT W/ CODE 4	13-004-1252	13-004-1252	13-004-1222	13-004-1222		13-004-1222
			SAE 'B' 2 BOLT	13-004-1182	13-004-1182	13-004-1232		13-004-1182	13-004-1232
			SAE 'B' 2 & 4 BOLT W/ CODE 4	13-004-1202	13-004-1202	13-004-1232	13-004-1232		13-004-1232
			SAE 'C' 2 AND 4 BOLT	13-004-1212	13-004-1212	13-004-1242		13-004-1242	13-004-1242
			SAE 'C' 2 AND 4 BOLT W/ CODE 4	13-004-1212	13-004-1212	13-004-1242	13-004-1242		13-004-1242
7	3	PLANET SHAFT (SEC)	83-004-1031	83-004-1031	83-004-1031	83-004-1031	83-004-1031	83-004-1031	
8	3	PLANET SHAFT (PRI)	13-004-1021	13-004-1021	13-004-1021	13-004-1021	13-004-1021	13-004-1021	
9	3	PLANET GEAR (SEC)	83-004-1272	83-004-1242	83-004-1272	83-004-1242	83-004-1242	83-004-1242	
10	3	PLANET GEAR (PRI)	13-004-1102	13-004-1102	13-004-1122	13-004-1112	13-004-1112	13-004-1122	
11	1	SUN GEAR	83-004-1282	83-004-1252	83-004-1282	83-004-1252	83-004-1252	83-004-1252	
INPUT GEAR	12	1	CODE 2 - INPUT - 13T 16/32 DP	13-004-1292	13-004-1292	13-004-1312		13-004-1302	13-004-1312
			CODE 3 - INPUT - SAE 1"-6B	13-004-1322	13-004-1322	13-004-1472		13-004-1332	13-004-1472
			CODE 4 - INPUT 14T 12/24 DP	13-004-1342	13-004-1342	13-004-1362	13-004-1352		13-004-1362
			CODE 5 - INPUT -15T 16/32 DP	13-004-1452	13-004-1452			13-004-1442	
			SHAFT- PER CUSTOMER SPEC	-	-	-	-	-	-
14	*	SHIMS	83-004-1101	83-004-1101	83-004-1101	83-004-1101	83-004-1101	83-004-1101	
15	12	THRUST WASHER- PLANET	81-004-1561	81-004-1561	81-004-1561	81-004-1561	81-004-1561	81-004-1561	
17	1	THRUST WASHER-INPUT	81-004-2701	81-004-2701	-	-	81-004-2701	-	
18	3	BEARING - PRI. PL.	01-105-0590	01-105-0590	01-105-0590	01-105-0590	01-105-0590	01-105-0590	
19	3	BEARING - SEC. PL.	01-105-0500	01-105-0500	01-105-0500	01-105-0500	01-105-0500	01-105-0500	
20	1	BEARING CONE	01-102-0200	01-102-0200	01-102-0200	01-102-0200	01-102-0200	01-102-0200	
21	1	BEARING CUP	01-103-0200	01-103-0200	01-103-0200	01-103-0200	01-103-0200	01-103-0200	
22	1	BEARING CONE	01-102-0100	01-102-0100	01-102-0100	01-102-0100	01-102-0100	01-102-0100	
23	1	BEARING CUP	01-103-0090	01-103-0090	01-103-0090	01-103-0090	01-103-0090	01-103-0090	
24	8	H.H.C.S. 3/8-16-1 1/2 GR8	01-150-1670	01-150-1670	01-150-1670	01-150-1670	01-150-1670	01-150-1670	
25	3	S.H.C.S. 1/2-20 2 1/2 GR8	01-150-1480	01-150-1480	01-150-1480	01-150-1480	01-150-1480	01-150-1480	
27	8	LOCKWASHER 3/8 MED	01-166-0010	01-166-0010	01-166-0010	01-166-0010	01-166-0010	01-166-0010	
28	3	ROLL PIN - SEC. PL. 3/16 X 7/8	01-153-0210	01-153-0210	01-153-0210	01-153-0210	01-153-0210	01-153-0210	
29	3	ROLL PIN - PRI. PL. 1/8 X 7/8	01-153-0180	01-153-0180	01-153-0180	01-153-0180	01-153-0180	01-153-0180	
30	1	O-RING	01-402-0420	01-402-0420	01-402-0420	01-402-0420	01-402-0420	01-402-0420	
31	1	SHAFT SEAL	01-405-0660	01-405-0660	01-405-0660	01-405-0660	01-405-0660	01-405-0660	
32	2	PIPE PLUG 3/8 NPT MAGNETIC	01-207-0070	01-207-0070	01-207-0070	01-207-0070	01-207-0070	01-207-0070	
36	1	BEARING	-	-	01-112-0220	01-112-0220	-	01-112-0220	
37	1	THRUST RACE-USED WITH 'BLIND SPLINE' INPUTS	-	-	01-112-0230	01-112-0230	-	01-112-0230	

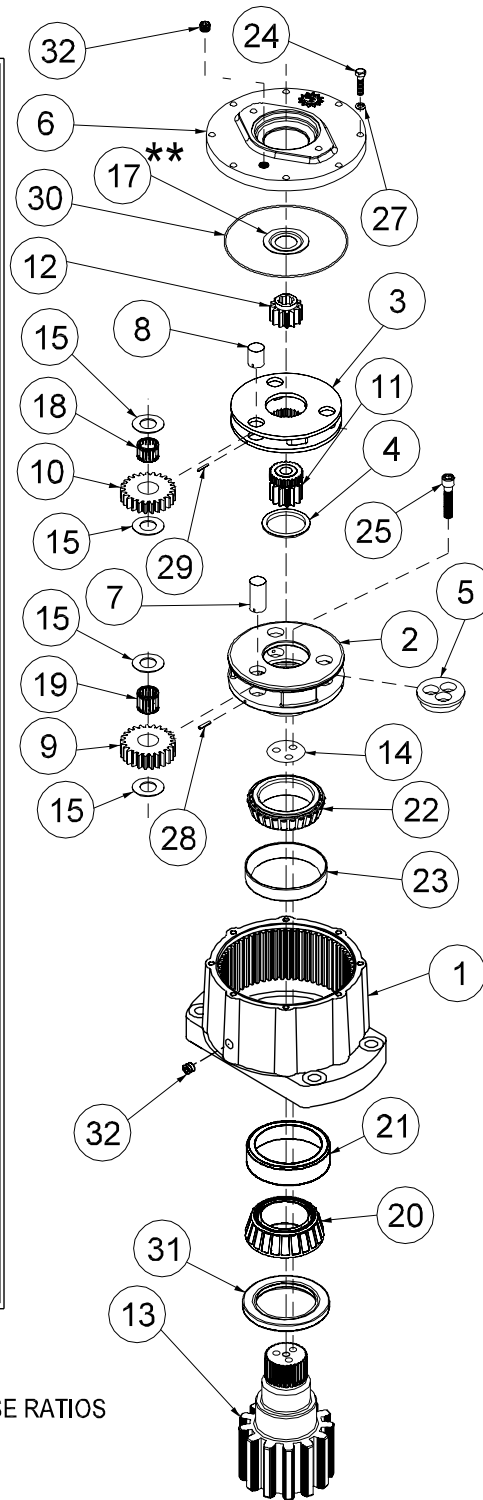

* QUANTITY OF SHIMS DETERMINED BY PRELOAD DESIRED AND PART STACK-UP
SEAL KIT P/N 86-016-0621 (INCLUDES 1 EACH OF ITEMS 30 & 31).

** REPLACE ITEM 17 WITH 1 EACH OF ITEM 36 & ITEM 4 AND 2 OF ITEM 37 FOR THESE RATIOS

FILENAME X105ED2-AA