



MODEL 600L WHEEL DRIVE

EQUIPPED WITH PATENTED "LOAD-LOCK" SHAFT
RETENTION SYSTEM (U.S. PATENT NO. 6746617).
*UNITS MANUFACTURED PRIOR TO SN 76300
UTILIZE (OBSOLETE) P/N 60-004-1301 FOR ITEM
64. P/N 60-004-1301 IS IDENTICAL TO
UNITS IDENTICAL TO CURRENT UNIT (SHOWN ON
THIS DRAWING)

EFFECTIVE
FROM SN 76300 08-01-08
TO (CURRENT)

NOTES:
-J- BEARING PRELOAD
DETERMINES QUANTITY OF SHIMS.
SEAL KIT (P/N 60-016-2101)
INCLUDES:
3 EA- ITEM (33) O-RINGS
3 EA- ITEM (48) SEAL AND
1 EA- ITEM (50) SEAL BOOT.

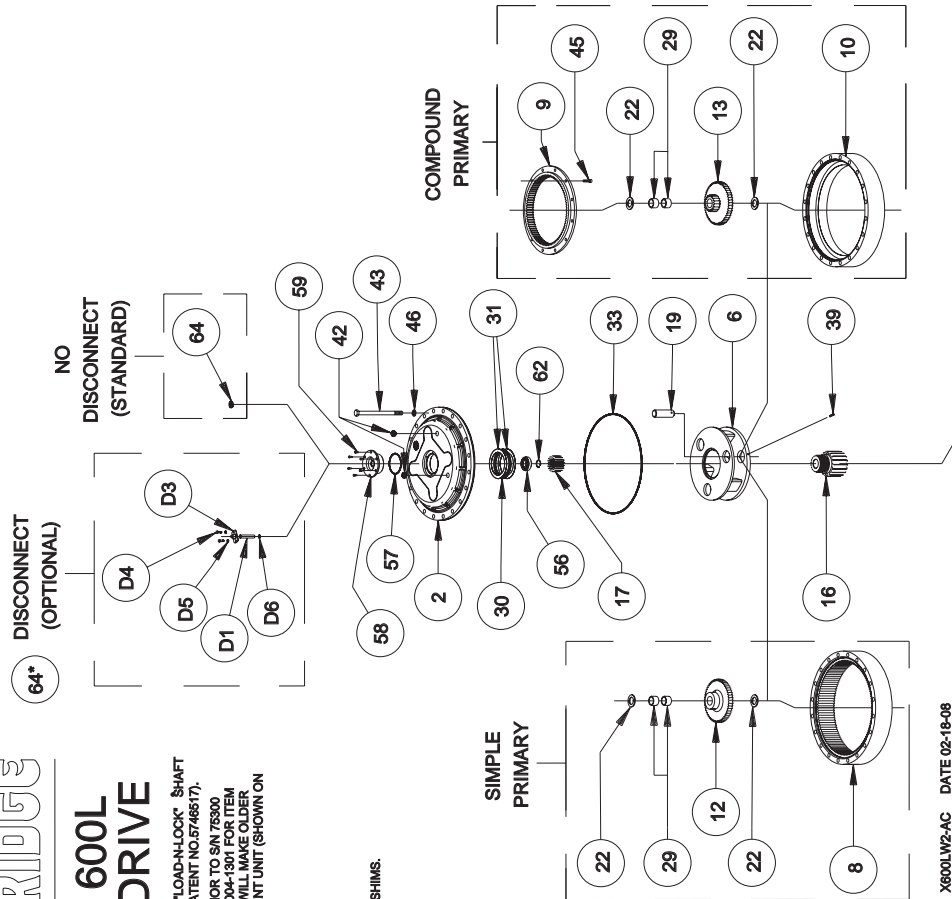

X600LW2-AC DATE 02-18-08

RATIOS →			SIMPLE PRIMARY			COMPOUND PRIMARY	
			23.66:1	37.56:1	59.29:1	69.39:1	109.08:1
<h1>MODEL 600L WHEEL DRIVE</h1>							
ITEM	QTY.	DESCRIPTION	PART NUMBER	PART NUMBER	PART NUMBER	PART NUMBER	PART NUMBER
1	1	CODE F - FLANGELESS	60-004-3034	60-004-3034	60-004-3034	60-004-3034	60-004-3034
		CODE A - FLANGED	60-004-3044	60-004-3044	60-004-3044	60-004-3044	60-004-3044
		600C_ - CUSTOM MTG - PER CUSTOMER SPECS.					
2	1	COVER	60-004-1444	60-004-1444	60-004-1444	60-004-1444	60-004-1444
3	1	CODE W/C - 17" DIA.; 12X 1 1/8 - 12 UNF-2B	60-004-4172L	60-004-4172L	60-004-4172L	60-004-4172L	60-004-4172L
		CODE W/D - 17" DIA.; 12X 1 1/8 - 12 UNF-2B	60-004-4072L	60-004-4072L	60-004-4072L	60-004-4072L	60-004-4072L
		CODE WC1 - CUSTOM					
5	1	CARRIER - SECONDARY	60-004-1044	60-004-1054	60-004-1054	60-004-1044	60-004-1054
6	1	CARRIER - PRIMARY	60-004-1014	60-004-1014	60-004-1024	60-004-1024	60-004-1024
7	1	RING GEAR - SECONDARY	60-004-1193	60-004-1193	60-004-1193	60-004-1193	60-004-1193
8	-	RING GEAR - SIMPLE PRIMARY	60-004-1193	60-004-1193	60-004-1193	-	-
9	1	RING GEAR - COMPOUND PRIMARY	-	-	-	60-004-1213	60-004-1213
10	1	RING SPACER - PRIMARY	-	-	-	60-004-1253	60-004-1253
11	3	PLANET GEAR - SECONDARY	60-004-1092	60-004-1112	60-004-1112	60-004-1092	60-004-1112
12	-	PLANET GEAR - PRIMARY	60-004-1132	60-004-1132	60-004-1152	-	-
13	3	CLUSTER GEAR	-	-	-	60-004-1162	60-004-1162
14	1	LOCK RING - SHAFT BEARING	60-004-1472	60-004-1472	60-004-1472	60-004-1472	60-004-1472
15	-J-	SHIM(S) - SHAFT	60-004-1311	60-004-1311	60-004-1311	60-004-1311	60-004-1311
16	1	SUN GEAR	60-004-1362	60-004-1362	60-004-1702	60-004-1362	60-004-1702
17	1	PRIMARY SUN GEAR (13T;8/16 SPLINE) HOLLOW	60-004-1802	60-004-1812	60-004-1812	60-004-1812	60-004-1812
18	3	PLANET SHAFT-SECONDARY	60-004-1262	60-004-1262	60-004-1262	60-004-1262	60-004-1262
19	3	PLANET SHAFT-PRIMARY	60-004-1272	60-004-1272	60-004-1272	60-004-1272	60-004-1272
20	-J-	SHIM(S) - SECONDARY PLANET	60-004-1321	60-004-1321	60-004-1321	60-004-1321	60-004-1321
21	6	WASHER - SECONDARY PLANET	60-004-1291	60-004-1291	60-004-1291	60-004-1291	60-004-1291
22	6	WASHER - PRIMARY PLANET	60-004-1881	60-004-1881	60-004-1881	60-004-1881	60-004-1881
23	1	BEARING CONE - SHAFT OUTER	01-102-0190	01-102-0190	01-102-0190	01-102-0190	01-102-0190
24	1	BEARING CUP - SHAFT OUTER	01-103-0190	01-103-0190	01-103-0190	01-103-0190	01-103-0190
25	1	BEARING CONE - SHAFT INNER	01-102-0230	01-102-0230	01-102-0230	01-102-0230	01-102-0230
26	1	BEARING CUP - SHAFT INNER	01-103-0230	01-103-0230	01-103-0230	01-103-0230	01-103-0230
27	6	CONE - SEC.PLANET	01-102-0210	01-102-0210	01-102-0210	01-102-0210	01-102-0210
28	6	CUP - SEC.PLANET	01-103-0210	01-103-0210	01-103-0210	01-103-0210	01-103-0210
29	6	BRG-PRIMARY PLANET	01-105-0510	01-105-0510	01-105-0510	01-105-0510	01-105-0510
30	1	BRG-PRI. CARR. THRUST	01-112-0340	01-112-0340	01-112-0340	01-112-0340	01-112-0340
31	2	RACE-PRI. CARR. THRUST	01-112-0350	01-112-0350	01-112-0350	01-112-0350	01-112-0350
33	3	O-RING - RING GEAR	01-402-0660	01-402-0660	01-402-0660	01-402-0660	01-402-0660
35	1	SPLIT RING	60-004-1482	60-004-1482	60-004-1482	60-004-1482	60-004-1482
36	3	RETAINING RING- SEC. PIN	01-160-0490	01-160-0490	01-160-0490	01-160-0490	01-160-0490
37	6	RETAINING RING-SEC. PLNT.	01-160-0500	01-160-0500	01-160-0500	01-160-0500	01-160-0500
39	6	ROLL PIN - PRI. 1/4 X 1 3/8	01-153-0150	01-153-0150	01-153-0150	01-153-0150	01-153-0150
41	1	PIPE PLUG 1/4 NPT	01-207-0020	01-207-0020	01-207-0020	01-207-0020	01-207-0020
42	6	PIPE PLUG 3/4 NPT MAGNETIC	01-207-0100	01-207-0100	01-207-0100	01-207-0100	01-207-0100
43	20	H.H.C.S 3/4-10 X 10.5 GRD 8	01-150-1580	01-150-1580	01-150-1580	01-150-1580	01-150-1580
45	12	S.H.C.S 1/2-13 X 1.5 GRD 8	-	-	-	01-150-0570	01-150-0570
46	20	LOCKWASHER - 3/4	01-166-0360	01-166-0360	01-166-0350	01-166-0350	01-166-0350
47	1	PLATE - SEC CARRIER RETAINER	60-004-1352	60-004-1352	60-004-1352	60-004-1352	60-004-1352
48	3	FLAT HD. SOC. C.S. 3/8-24 X 1 GR8	01-150-1590	01-150-1590	01-150-1590	01-150-1590	01-150-1590
49	1	SEAL - METAL FACE	01-406-0010	01-406-0010	01-406-0010	01-406-0010	01-406-0010
50	1	SEAL - RUBBER FACE	01-406-0020	01-406-0020	01-406-0020	01-406-0020	01-406-0020
51	1	PIPE PLUG (1/8 NPT-HOLLOW HEX)	01-207-0030	01-207-0030	01-207-0030	01-207-0030	01-207-0030
52	1	GREASE FITTING-STRAIGHT, 1/8 NPT	01-215-0010	01-215-0010	01-215-0010	01-215-0010	01-215-0010
53	1	CODE 3: 14T, 12/24 D.P., LONG SHAFT (OPTIONAL)	98-005-1141	98-005-1141	98-005-1141	98-004-1141	98-004-1141
		CODE 4: 14T, 12/24 D.P. (OPTIONAL)	60-004-1943	60-004-1943	60-004-1943	60-004-1943	60-004-1943
		CODE 7: 17T, 12/24 D.P. (OPTIONAL)	60-004-1944	60-004-1944	60-004-1944	60-004-1944	60-004-1944
54	(1)	CODE V - AIR VENT; 1/8 NPT (OPTIONAL)	01-216-0030	01-216-0030	01-216-0030	01-216-0030	01-216-0030
55	(1)	ADAPTER; 3/4" NPT-M, 1/8" NPT - F (OPTIONAL)	01-201-0530	01-201-0530	01-201-0530	01-201-0530	01-201-0530
56	1	BALL BEARING (7207 WN)	01-100-0320	01-100-0320	01-100-0320	01-100-0320	01-100-0320
57	1	O - RING (#242)	01-402-0220	01-402-0220	01-402-0220	01-402-0220	01-402-0220
58	1	THRUST HUB	60-004-1822	60-004-1822	60-004-1822	60-004-1822	60-004-1822
59	6	SHCS (1/4-20 X 1/2 GR8)	01-150-0560	01-150-0560	01-150-0560	01-150-0560	01-150-0560
60	1	INPUT SHAFT - 13T HOLLOW SPINDLE	60-004-1392	60-004-1392	60-004-1392	60-004-1392	60-004-1392
61	1	CODE 4, 7 & 8: 16T, 8/16 D.P. INPUT COUPLING	60-004-1422	60-004-1422	60-004-1422	60-004-1422	60-004-1422
		CODE 3 & 9: 13T, 8/16 D.P. INPUT COUPLING	60-004-1692	60-004-1692	60-004-1692	60-004-1692	60-004-1692
62	2	RETAINING RING (#5000-150)	01-160-0580	01-160-0580	01-160-0580	01-160-0580	01-160-0580
63	1	RETAINING RING (#5000-300)	01-160-0060	01-160-0060	01-160-0060	01-160-0060	01-160-0060
64	1	PLUG SAE #14 (MODELS W/OUT DISCONNECT)	01-208-0080	01-208-0080	01-208-0080	01-208-0080	01-208-0080
		DISCONNECT OPTION KIT (ITEMS D1-D6)	60-005-2143	60-005-2143	60-005-2143	60-005-2143	60-005-2143
D1	1	DOWEL PIN (5/8 x 3-1/2)	01-152-0130	01-152-0130	01-152-0130	01-152-0130	01-152-0130
D2	1	SPRING 6.0 x .75 x .54 x 23 lb/in	01-261-0550	01-261-0550	01-261-0550	01-261-0550	01-261-0550
D3	1	DISCONNECT PLATE	60-004-1832	60-004-1832	60-004-1832	60-004-1832	60-004-1832
D4	2	HHCS; 5/16-18 x 1 GR5	01-150-1790	01-150-1790	01-150-1790	01-150-1790	01-150-1790
D5	2	LOCKWASHER (5/16)	01-166-0110	01-166-0110	01-166-0110	01-166-0110	01-166-0110
D6	1	O-RING (#016)	01-402-0900	01-402-0900	01-402-0900	01-402-0900	01-402-0900