

76BA & 76BC (TWO SPEED)

ITEM	QTY	76BA	76BC	DESCRIPTION
1	1	71-004-0014	→	TOP CASE
2	1	71-004-2144	→	BEARING CARRIER
3	1	01-103-0080	→	BRG., LOWER SHAFT CUP
4	1	71-004-0042	→	RING GEAR, SEC.
5	1	71-004-0142	→	RING GEAR, PRI.
6	1	71-004-0073	→	PLANET CARRIER, SEC.
7	1	71-004-0113	71-004-0433	PLANET CARRIER, PRI.
8	3	71-004-0081	→	PLANET PIN, SEC.
9	3	71-004-0121	→	PLANET PIN, PRI.
10	3	71-004-0092	→	PLANET GEAR, SEC.
11	3	71-004-0132	71-004-0412	CLUSTER GEAR, PRI.
12	1	71-004-0102	→	SUN GEAR, SEC.
13	1	71-004-0172	71-004-0402	SUN GEAR, PRI.
15	1	71-004-0562	71-004-0572	SHIFTER GEAR
16	1	71-004-0772	→	SHIFTER COLLAR
17	6	71-004-0861	→	WASHER, PRI.
18	6	71-004-0871	→	WASHER, SEC.
19	1	71-005-0302	→	SHIFTER SHAFT ASSY
20	1	PER CUSTOMER SPEC		BAIL ASSY
21	1	01-102-0100	→	BRG., UPPER SHAFT CONE
22	1	01-100-0040	→	BRG., SHIFTER
23	6	01-105-0010	→	BRG., PRI. PLANET
24	3	01-105-0020	→	BRG., SEC. PLANET
25	1	01-102-0090	→	BRG., LOWER SHAFT CONE
26	1	01-112-0030	→	THRUST RACE
27	1	01-127-0010	→	BUSHING
28	1	71-004-0151	→	BUSHING
29	12	01-150-0020	→	CAP. SCR., 3/8-16
30	1	01-103-0090	→	BRG., UPPER SHAFT CUP
31	2	01-150-0110	→	CAP. SCR., 5/8-11
32	8	01-150-0520	→	CAP. SCR., S.H., 3/8-16
33	6	01-153-0020	→	ROLL PIN, 3/16
34	12	01-158-0360	→	HEX. FLANGE NUT, 3/8-16
35	1	01-160-0100	→	SNAP RING, INT., NO. 288
36	1	01-160-0030	→	SNAP RING, EXT., NO. 255
37	1	01-160-0020	→	SNAP RING, EXT., NO. 237
38	1	01-160-0040	→	SNAP RING, EXT., NO. 250
39	1	01-160-0110	→	SNAP RING, EXT., NO. 156
40	2	01-166-0040	→	LOCKWASHER, 5/8
41	2	01-207-0010	→	PIPE PLUG, 1/2 NPT
42	1	SHIFT CYLINDER ASSEMBLIES		
		71-002-0601	→	SINGLE ACTING (STD) HYD.
		71-002-1351	→	SINGLE ACT. HEAVY DUTY HYD
		71-002-0692	→	DOUBLE ACTING HYD.
		71-002-0322	→	AIR
71-002-1542	→	VACUUM		
43	1	01-402-0010	→	O-RING, NO. 250
44	2	01-402-0020	→	O-RING, NO. 276
46	1	01-405-0540	→	OIL SEAL
47	2	01-152-0070	→	DOWEL PIN
49	1	71-004-0513	→	2-1/2" HEX. OUTPUT SHAFT
		71-004-1383	→	2-5/8" HEX. OUTPUT SHAFT
50	1	PER CUSTOMER SPEC		HYDRAULIC MOTOR

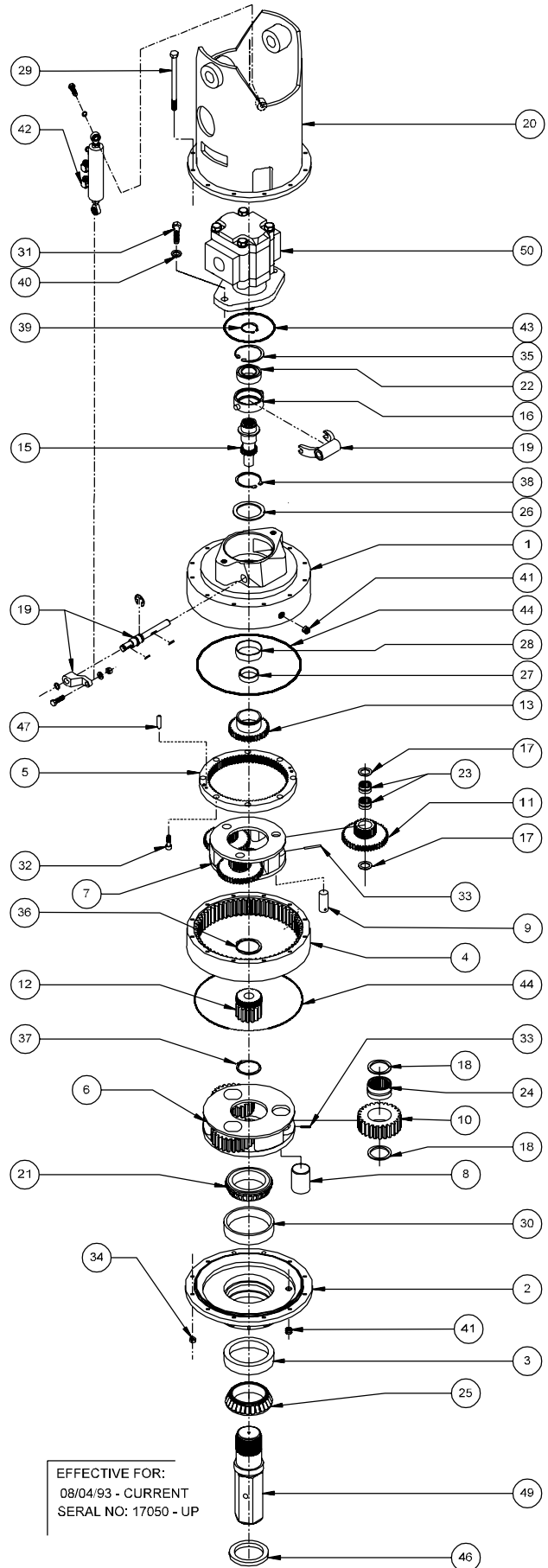

OPTIONS
 SEAL KIT P/N 76-016-2011
 INCLUDES ITEMS 43, 44, 46 AND
 O-RING FOR SHIFTER SHAFT ASSEMBLY.

E.C.N. 1803
 X76-AB DATE: 4-27-00

EFFECTIVE FOR:
 08/04/93 - CURRENT
 SERIAL NO: 17050 - UP